

Features

- Miniature size
- Poppet design contributes to long product life
- Seven input options
- Swivel input port
- Closed crossover (NC *Only*)
- Vacuum option available (NC *Only*)



2 & 3-Way Valves

"O" Series

The highly reliable "O" Series valve is available in 2-Way or 3-Way normally open or normally closed. Ideal for limited space applications (OAL not more than 2.43") this miniature valve features seven swivel input options- virtually eliminating the need for additional fittings!

Closed cross-over The normally closed "O" series features a stem and poppet that work in conjunction with one another. The poppet seals the exhaust port before it opens to flow (normally closed). There is no transitional state from one function to the next providing the user precise control between positions.

Performance Data

Temperature Range	Operating Pressure	C _v	Flow Rate (scfm)		Fill Time sec/ in ³ 0-90 psi	Exhaust Time sec/ in ³ 100-10 psi
			50 psi	125 psi		
-20° to 160° F	0 to 125 psi	.24	8.2	17.3	.02	.06

- *Vacuum option available on "O" Series NC (Only) up to 10" Hg. See "200", "300", and "400" Series for applications greater than 10" Hg.*

C_v per ANSI / (NFPA) T3.21.3

Actuation Force

Actuator Style	2-Way Valve		3-Way Valve	
	50 psi	125 psi	50 psi	125 psi
Nylon Toggle	4 oz	6 oz	4 oz	6 oz
Push Button	3 lbs	5 1/2 lbs	3 lbs	5 1/2 lbs

Actuation force for NC **ONLY**

Materials

Aluminum/ Anodize or Brass/ Electroless Nickel, Acetal, Stainless Steel, Nylon, Buna-N (optional seals available- contact factory)

“O” Series Cut-away 3-Way Normally Closed

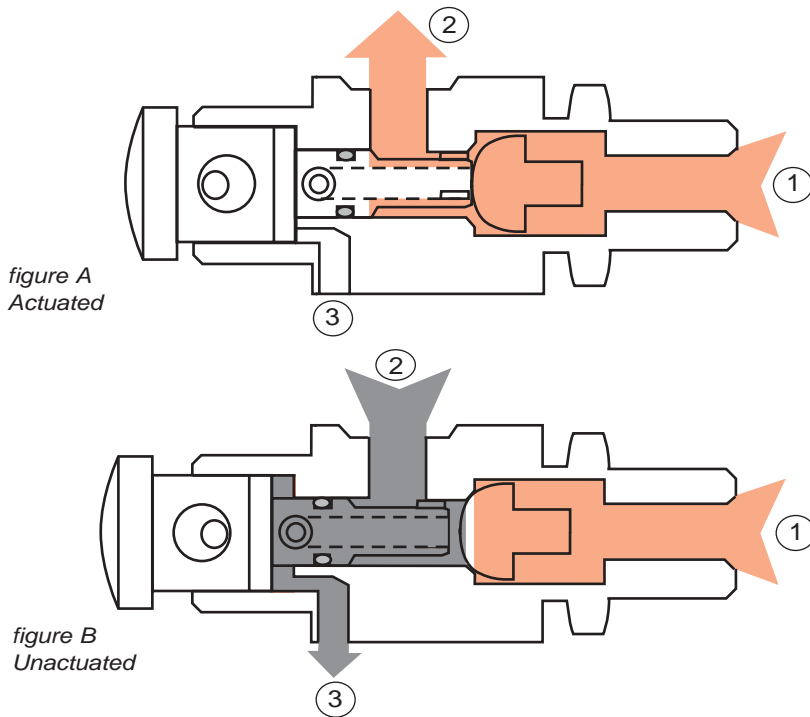

Function

When a 3-Way normally closed valve is actuated (figure A) the stem unseats the poppet allowing flow through port 1 around the poppet and stem and out port 2.

In the unactuated position (figure B) the **poppet** is seated. When flow enters from port 2 it travels through the hollow stem and exhausts to atmosphere through port 3. The poppet design provides a large durable surface that can withstand millions of cycles.

The *normally open* “O” Series features a stem design with standard Buna-N O-rings.

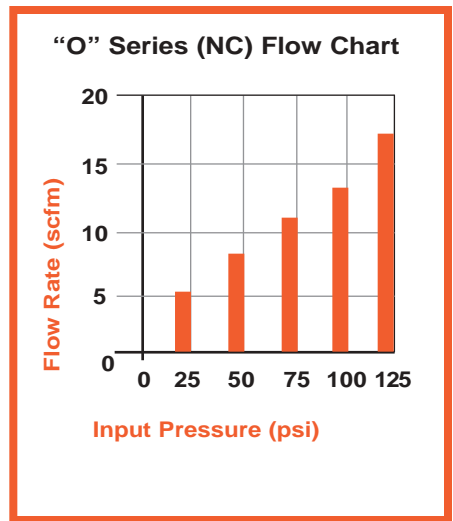

Valves
“O” Series

Port Options

Definition	Options
Port 1 Swivel Input	<ul style="list-style-type: none"> ● 1/8 NPT (M)/ 10-32 (F) ● 10-32 (F) Elbow ● 10-32 (F) Tee ● 1/8 NPT (F) ● 170 Barb* ● 1/4 Push-in ● 5/32 Push-in
Port 2 Output	10-32 (F)
Port 3 Exhaust	non-threaded, exhausts to atmosphere

*170 barb- recommended for use with 1/8 ID PUR or .170 ID PE

Swivel input is NOT to be used as a rotary union

Mounting Method

Panel	Surface
Nominal mounting hole dimension 31/64"	MB-1 or MB-1F Mounting Bracket

(2) nuts and (1) lockwasher provided

Ordering Information

- To order standard product use part number listing.
- Optional seals available- contact factory.
- Electroless Nickel option add "N" to the end of the standard product number.
- Vacuum option add "-VAC" to standard product number (NC Only).
- Metal push button available- use an "M" as the second character to indicate metal.
- Nylon toggles and push buttons are available in seven colors with black as standard. To order colored actuator specify the color, by code, as a "-code#" suffix following the part number (see color code chart page 91).

***Pneumadyne
"O" Series Valves
have been customer
tested over
40 million cycles!***

Product Information

2-Way Normally Closed

	Part Number	Input
Push Button	AO-20-1	1/8 NPT /10-32 (F)
	AO-20-2	10-32 (F) Elbow
	AO-20-3	10-32 (F) Tee
	AO-20-4	1/8 NPT (F)
	AO-20-5	170 Barb
	AO-20-6	1/4 Push-in
	AO-20-7	5/32 Push-in
Detented Toggle	HO-20-1	1/8 NPT /10-32 (F)
	HO-20-2	10-32 (F) Elbow
	HO-20-3	10-32 (F) Tee
	HO-20-4	1/8 NPT (F)
	HO-20-5	170 Barb
	HO-20-6	1/4 Push-in
	HO-20-7	5/32 Push-in
Momentary Toggle	FO-20-1	1/8 NPT /10-32 (F)
	FO-20-2	10-32 (F) Elbow
	FO-20-3	10-32 (F) Tee
	FO-20-4	1/8 NPT (F)
	FO-20-5	170 Barb
	FO-20-6	1/4 Push-in
	FO-20-7	5/32 Push-in

3-Way Normally Closed

	Part Number	Input
Push Button	AO-30-1	1/8 NPT /10-32 (F)
	AO-30-2	10-32 (F) Elbow
	AO-30-3	10-32 (F) Tee
	AO-30-4	1/8 NPT (F)
	AO-30-5	170 Barb
	AO-30-6	1/4 Push-in
	AO-30-7	5/32 Push-in
Detented Toggle	HO-30-1	1/8 NPT /10-32 (F)
	HO-30-2	10-32 (F) Elbow
	HO-30-3	10-32 (F) Tee
	HO-30-4	1/8 NPT (F)
	HO-30-5	170 Barb
	HO-30-6	1/4 Push-in
	HO-30-7	5/32 Push-in
Momentary Toggle	FO-30-1	1/8 NPT /10-32 (F)
	FO-30-2	10-32 (F) Elbow
	FO-30-3	10-32 (F) Tee
	FO-30-4	1/8 NPT (F)
	FO-30-5	170 Barb
	FO-30-6	1/4 Push-in
	FO-30-7	5/32 Push-in

2-Way Normally Open

	Part Number	Input
Push Button	AO-21-1	1/8 NPT /10-32 (F)
	AO-21-2	10-32 (F) Elbow
	AO-21-3	10-32 (F) Tee
	AO-21-4	1/8 NPT (F)
	AO-21-5	170 Barb
	AO-21-6	1/4 Push-in
	AO-21-7	5/32 Push-in
Detented Toggle	HO-21-1	1/8 NPT /10-32 (F)
	HO-21-2	10-32 (F) Elbow
	HO-21-3	10-32 (F) Tee
	HO-21-4	1/8 NPT (F)
	HO-21-5	170 Barb
	HO-21-6	1/4 Push-in
	HO-21-7	5/32 Push-in
Momentary Toggle	FO-21-1	1/8 NPT /10-32 (F)
	FO-21-2	10-32 (F) Elbow
	FO-21-3	10-32 (F) Tee
	FO-21-4	1/8 NPT (F)
	FO-21-5	170 Barb
	FO-21-6	1/4 Push-in
	FO-21-7	5/32 Push-in

3-Way Normally Open

	Part Number	Input
Push Button	AO-31-1	1/8 NPT /10-32 (F)
	AO-31-2	10-32 (F) Elbow
	AO-31-3	10-32 (F) Tee
	AO-31-4	1/8 NPT (F)
	AO-31-5	170 Barb
	AO-31-6	1/4 Push-in
	AO-31-7	5/32 Push-in
Detented Toggle	HO-31-1	1/8 NPT /10-32 (F)
	HO-31-2	10-32 (F) Elbow
	HO-31-3	10-32 (F) Tee
	HO-31-4	1/8 NPT (F)
	HO-31-5	170 Barb
	HO-31-6	1/4 Push-in
	HO-31-7	5/32 Push-in
Momentary Toggle	FO-31-1	1/8 NPT /10-32 (F)
	FO-31-2	10-32 (F) Elbow
	FO-31-3	10-32 (F) Tee
	FO-31-4	1/8 NPT (F)
	FO-31-5	170 Barb
	FO-31-6	1/4 Push-in
	FO-31-7	5/32 Push-in

- Refer to page 12 for **Product Number Diagram**

Push Button Actuator

Toggle Actuator

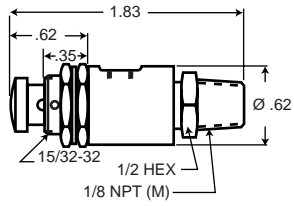

“-1” Input

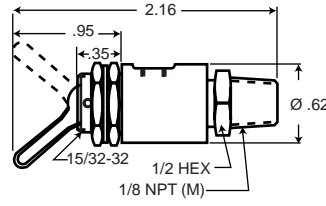

“-1” Input

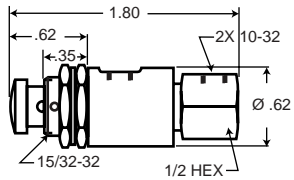

“-2” Input

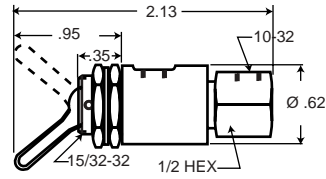

“-2” Input

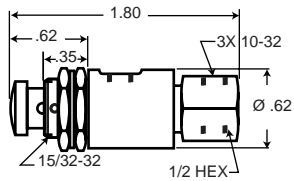

“-3” Input

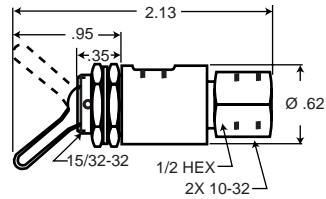

“-3” Input

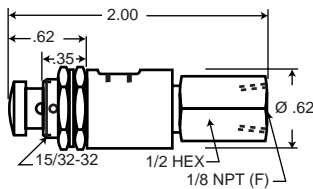

“-4” Input

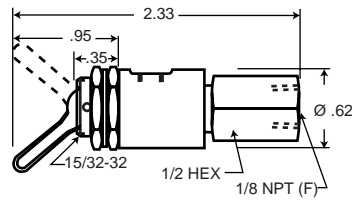

“-4” Input

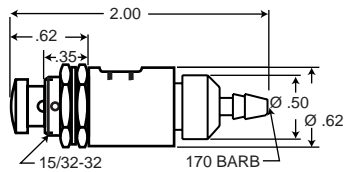

“-5” Input

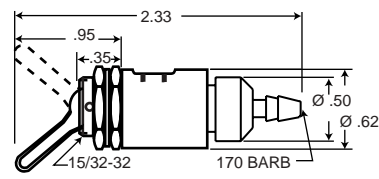

“-5” Input

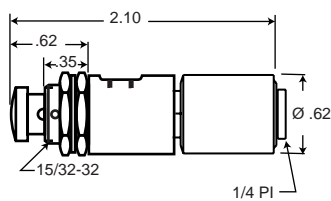

“-6” Input

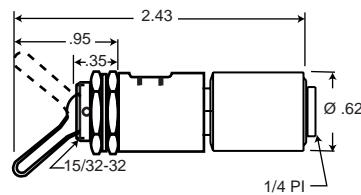

“-6” Input

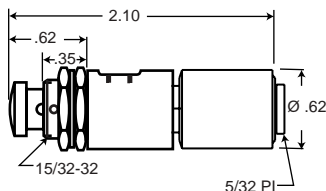

“-7” Input

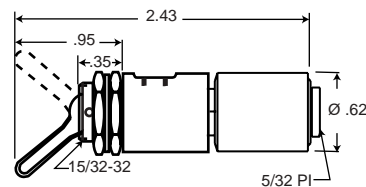

“-7” Input

● When design makes a dimension critical- contact factory for confirmation. All dimensions shown subject to change without notice.

Features

- Miniature size
- Fully ported 10-32 (F) 3-Way normally closed
- Poppet design contributes to long product life
- Seven input options
- Closed crossover
- Swivel Input Port
- Vacuum option available



3-Way Valves

"3" Series

The Pneumadyne "3" Series are 3-way normally closed fully ported valves.

Closed cross-over The normally closed "3" Series features a stem and poppet that work in conjunction with one another. The poppet seals the exhaust port before it opens to flow. There is no transitional state from one function to the next providing the operator precise control between positions.

The addition of the **threaded exhaust port** makes it possible to direct and capture the exhaust flow in liquid, clean-room or lubricated air applications.

Mufflers can also be threaded in the exhaust port for noise control.

Performance Data

Temperature Range	Operating Pressure	Flow Path	C _v	Flow Rate (scfm)		Fill Time sec/ in ³ 0-90 psi	Exhaust Time sec/ in ³ 100-10 psi
				50 psi	125 psi		
-20° to 160° F	0 to 125 psi	1-2	.23	7.2	15.4	.02	.04
		3-2	.09	3.7	8.0	.07	N/A

● Vacuum option available on "3" Series- for applications greater than 10 Hg- contact factory.

C_v per ANSI / (NFPA) T3.21.3

Actuation Force

Actuator Style	3-Way Valve	
	50 psi	125 psi
Nylon Toggle	8 oz	14 oz
Push Button	3 1/2 lbs	6 lbs

Materials

Aluminum/ Anodize or Brass/ Electroless Nickel, Acetal, Stainless Steel, Nylon, Buna-N (optional seals available -contact factory)

"3" Series Cut-away 3-Way Normally Closed

figure A
Actuated

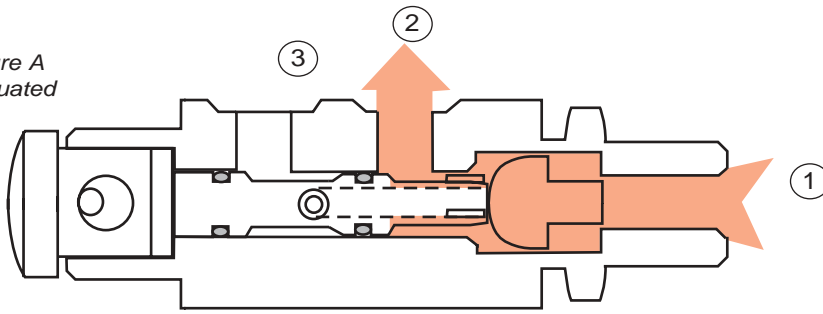
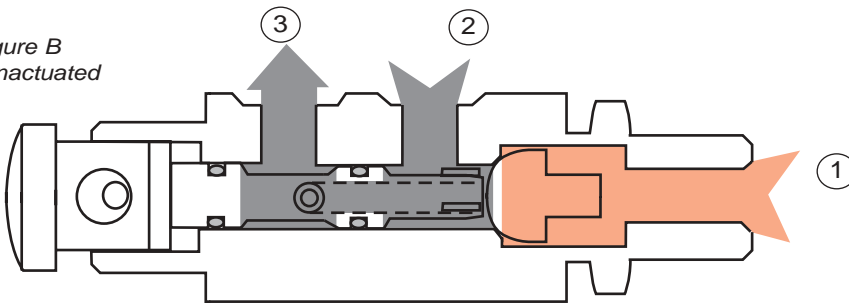

figure B
Unactuated



Function

When a 3-Way normally closed valve is actuated (figure A) the stem unseats the poppet allowing flow through port 1 around the poppet and stem and out port 2.

In the unactuated position (figure B) the **poppet** is seated. When flow enters from port 2 it travels through the hollow stem and exhausts to atmosphere through port 3. The poppet design provides a large durable surface that can withstand millions of cycles.

This versatile valve can be plumbed as a selector with pressure in port 1 and vacuum plumbed in port 3.

Pick-and-place applications use selector valves to pick up an object, often with a suction cup at port 2, and release the object by breaking the vacuum pressure at port 1.

The "3" Series cannot be plumbed as normally open, we recommend using our "300" Series 10-32 fully ported valve.

"3" Series Flow Chart

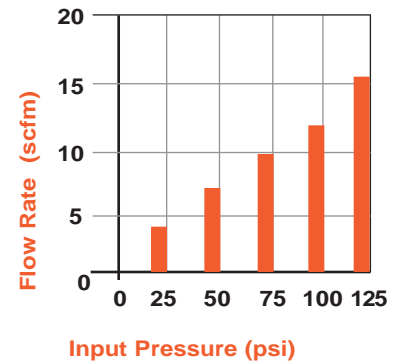

Port Options

Definition	Options
Port 1 Swivel Input	<ul style="list-style-type: none"> ● 1/8 NPT (M)/ 10-32 (F) ● 10-32 (F) Elbow ● 10-32 (F) Tee ● 1/8 NPT (F) ● 170 Barb* ● 1/4 Push-in ● 5/32 Push-in
Port 2 Output	10-32 (F)
Port 3 Exhaust	10-32 (F)

*170 barb- recommended for use with 1/8 ID PUR or .170 ID PE

Swivel input is NOT to be used as a rotary union

Mounting Method

Panel	Surface
Nominal mounting hole dimension 31/64"	MB-1 or MB-1F Mounting Bracket

(2) nuts and (1) lockwasher provided

The standard "3" Series valve input port swivels to accommodate critical alignment

Product Information

3-Way Normally Closed

	Part Number	Input
Push Button	A3-30-1	1/8 NPT/ 10-32 (F)
	A3-30-2	10-32 (F) Elbow
	A3-30-3	10-32 (F) Tee
	A3-30-4	1/8 NPT (F)
	A3-30-5	170 Barb
	A3-30-6	1/4 Push-in
	A3-30-7	5/32 Push-in
Detented Toggle	H3-30-1	1/8 NPT/ 10-32 (F)
	H3-30-2	10-32 (F) Elbow
	H3-30-3	10-32 (F) Tee
	H3-30-4	1/8 NPT (F)
	H3-30-5	170 Barb
	H3-30-6	1/4 Push-in
	H3-30-7	5/32 Push-in
Momentary Toggle	F3-30-1	1/8 NPT/ 10-32 (F)
	F3-30-2	10-32 (F) Elbow
	F3-30-3	10-32 (F) Tee
	F3-30-4	1/8 NPT (F)
	F3-30-5	170 Barb
	F3-30-6	1/4 Push-in
	F3-30-7	5/32 Push-in

Product Number Diagram

"O" Series & "3" Series

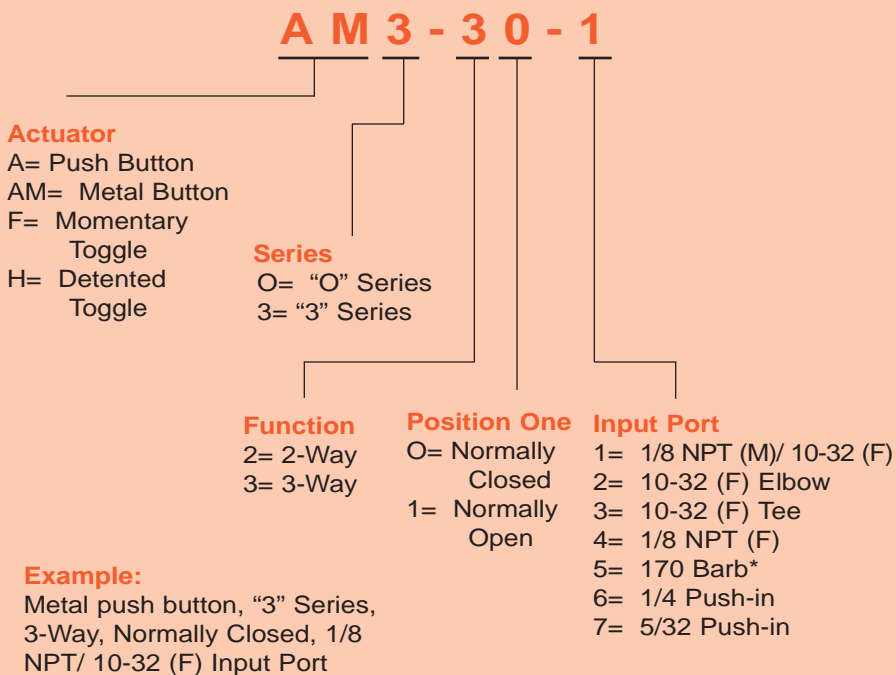

*170 barb- recommended for use with 1/8 ID PUR or .170 ID PE

Ordering Information

- To order standard product use part number listing.
- Metal push button available- use an "M" as the second character to indicate metal.
- Optional seals available- contact factory.
- To order vacuum option- add "-VAC" to the standard product number.
- Nylon toggles and push buttons are available in seven colors with black as standard. To order colored actuator specify the color, by code, as a "-code#" suffix following the part number (see color code chart page 91).

Push Button Actuator

Toggle Actuator

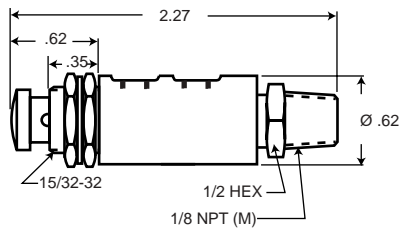

"-1" Input

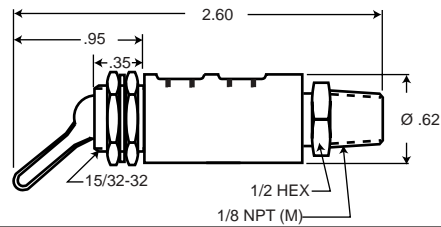

"-1" Input

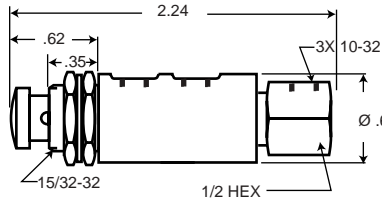

"-2" Input

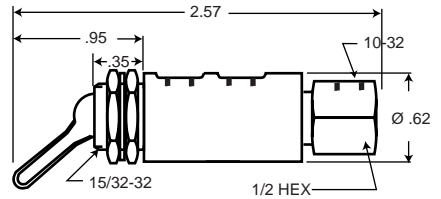

"-2" Input

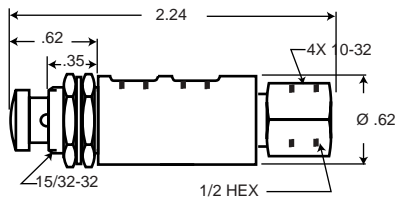

"-3" Input

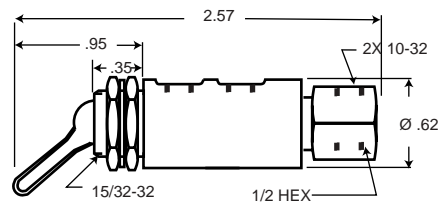

"-3" Input

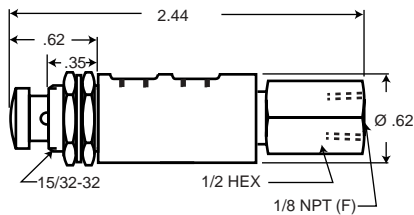

"-4" Input

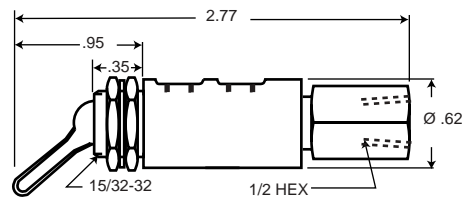

"-4" Input

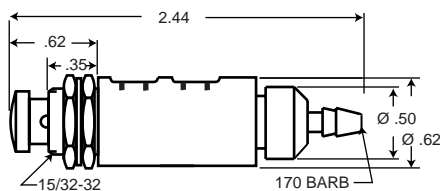

"-5" Input

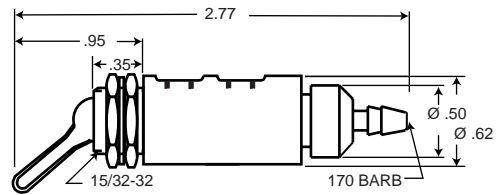

"-5" Input

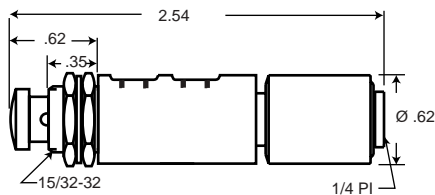

"-6" Input

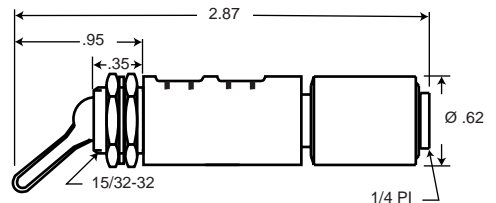

"-6" Input

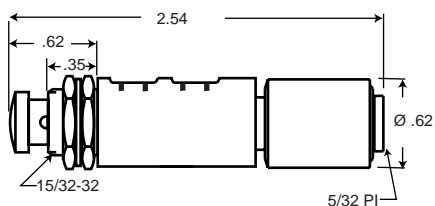

"-7" Input

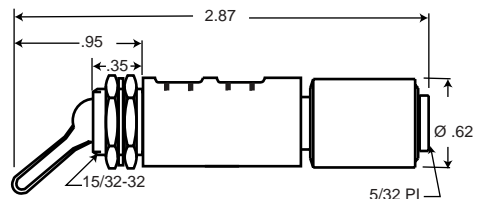

"-7" Input

● When design makes a dimension critical- contact factory for confirmation.
All dimensions shown subject to change without notice.

Features

- 158 possible configurations
- Four input options
- Swivel output port
- High flow
- Poppet design contributes to long product life
- Closed crossover (NC Only)



2 & 3-Way Valves "11" Series

The "11" Series features 1/8 NPT female and 1/4 push-in connections contributing to higher flow rates. Push-in connections are available on both the input and output ports for plumbing convenience.

Closed cross-over The normally closed "11" series features a stem and poppet that work in conjunction with one another. The poppet seals the exhaust port before it opens to flow (normally closed). There is no transitional state from one function to the next providing the operator precise control between positions.

Performance Data

Temperature Range	Operating Pressure	Type	C _v	Flow Rate (scfm)		Fill Time sec/ in ³ 0-90 psi	Exhaust Time sec/ in ³ 100-10 psi
				50 psi	125 psi		
-20° to 160° F	0 to 125 psi	Normally Open	.29	10.2	22.1	.01	.03
		Normally Closed	.29	10.2	22.1	.01	.05

C_v per ANSI / (NFPA) T3.21.3

Actuation Force

Actuator Style	Normally Open		Normally Closed	
	50 psi	125 psi	50 psi	125 psi
Nylon Toggle	8 oz	19 oz	8 oz	14 oz
Push Button	7 1/2 lbs	11 lbs	3 1/2 lbs	7 lbs

Materials

Aluminum/ Anodize, Brass/ Electroless Nickel, Stainless Steel, Nylon, Acetal Copolymer, Buna-N (optional seals available-contact factory)

"11" Series Cut-away 3-Way Normally Closed

figure A
Actuated

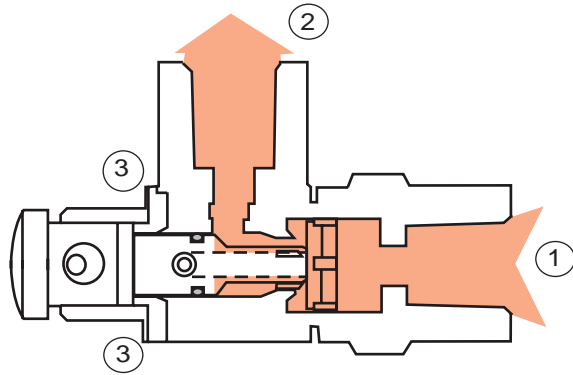
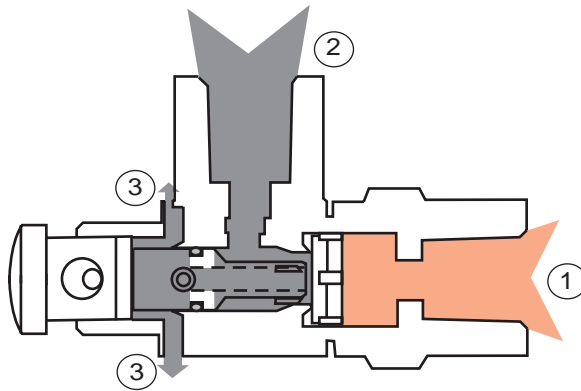

figure B
Unactuated



Function

When a 3-way normally closed valve is actuated (figure A) the stem unseats the poppet allowing flow through port 1 around the poppet and stem and out port 2.

In the unactuated position (figure B) the poppet is seated. When flow enters from port 2 it travels through the hollow stem and exhausts to atmosphere through port 3. The specially designed **poppet** has a Buna-N sealing surface which can withstand millions of cycles.

"11" Series Flow Chart

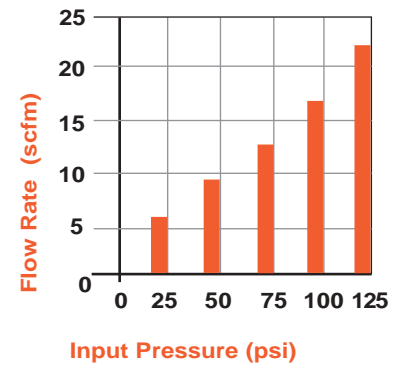

Port Options

Definition	Options
Port 1 Input	<ul style="list-style-type: none"> ● 1/8 NPT (M)/ 10-32 (F) ● 1/8 NPT (F) ● 1/4 Push-in ● 5/32 Push-in
Port 2 Swivel Output	<ul style="list-style-type: none"> ● 1/8 NPT (F) ● 1/4 Push-in ● 5/32 Push-in
Port 3 Exhaust	non-threaded, exhausts to atmosphere

Swivel output is NOT to be used as a rotary union

Mounting Method

Panel	Surface
Nominal mounting hole dimension 31/64"	MB-1 or MB-1F Mounting Bracket

(2) nuts and (1) lockwasher provided

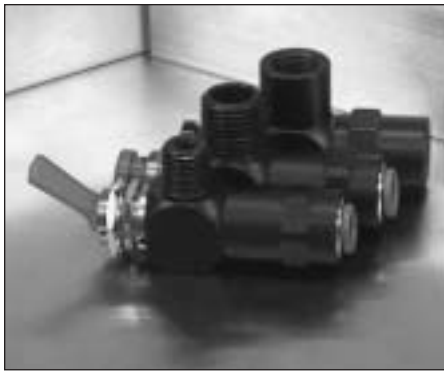

1/8 NPT male or 1/4 NPT male output ports available- contact factory

Product Information

2-Way Normally Closed

	Part Number	Input	Output
Push Button	A11-20-14	1/8	1/8 NPT (F)
	A11-20-16	NPT (M)	1/4 Push-in
	A11-20-17		5/32 Push-in
	A11-20-44	1/8	1/8 NPT (F)
	A11-20-46	NPT (F)	1/4 Push-in
	A11-20-47		5/32 Push-in
	A11-20-64		1/8 NPT (F)
	A11-20-66	1/4 Push-in	1/4 Push-in
	A11-20-67		5/32 Push-in
	A11-20-74		1/8 NPT (F)
Detented Toggle	A11-20-76	5/32 Push-in	1/4 Push-in
	A11-20-77		5/32 Push-in
	H11-20-14	1/8	1/8 NPT (F)
	H11-20-16	NPT (M)	1/4 Push-in
	H11-20-17		5/32 Push-in
	H11-20-44	1/8	1/8 NPT (F)
	H11-20-46	NPT (F)	1/4 Push-in
	H11-20-47		5/32 Push-in
	H11-20-64		1/8 NPT (F)
	H11-20-66	1/4 Push-in	1/4 Push-in
Momentary Toggle	H11-20-67		5/32 Push-in
	H11-20-74		1/8 NPT (F)
	H11-20-76	5/32 Push-in	1/4 Push-in
	H11-20-77		5/32 Push-in
	F11-20-14	1/8	1/8 NPT (F)
	F11-20-16	NPT (M)	1/4 Push-in
	F11-20-17		5/32 Push-in
	F11-20-44	1/8	1/8 NPT (F)
	F11-20-46	NPT (F)	1/4 Push-in
	F11-20-47		5/32 Push-in
F11-20-64		1/8 NPT (F)	
F11-20-66	1/4 Push-in	1/4 Push-in	
F11-20-67		5/32 Push-in	
F11-20-74		1/8 NPT (F)	
F11-20-76	5/32 Push-in	1/4 Push-in	
F11-20-77		5/32 Push-in	

2-Way Normally Open

	Part Number	Input	Output
Push Button	A11-21-14	1/8	1/8 NPT (F)
	A11-21-16	NPT (M)	1/4 Push-in
	A11-21-17		5/32 Push-in
	A11-21-44	1/8	1/8 NPT (F)
	A11-21-46	NPT (F)	1/4 Push-in
	A11-21-47		5/32 Push-in
	A11-21-64		1/8 NPT (F)
	A11-21-66	1/4 Push-in	1/4 Push-in
	A11-21-67		5/32 Push-in
	A11-21-74		1/8 NPT (F)
Detented Toggle	A11-21-76	5/32 Push-in	1/4 Push-in
	A11-21-77		5/32 Push-in
	H11-21-14	1/8	1/8 NPT (F)
	H11-21-16	NPT (M)	1/4 Push-in
	H11-21-17		5/32 Push-in
	H11-21-44	1/8	1/8 NPT (F)
	H11-21-46	NPT (F)	1/4 Push-in
	H11-21-47		5/32 Push-in
	H11-21-64		1/8 NPT (F)
	H11-21-66	1/4 Push-in	1/4 Push-in
Momentary Toggle	H11-21-67		5/32 Push-in
	H11-21-74		1/8 NPT (F)
	H11-21-76	5/32 Push-in	1/4 Push-in
	H11-21-77		5/32 Push-in
	F11-21-14	1/8	1/8 NPT (F)
	F11-21-16	NPT (M)	1/4 Push-in
	F11-21-17		5/32 Push-in
	F11-21-44	1/8	1/8 NPT (F)
	F11-21-46	NPT (F)	1/4 Push-in
	F11-21-47		5/32 Push-in
F11-21-64		1/8 NPT (F)	
F11-21-66	1/4 Push-in	1/4 Push-in	
F11-21-67		5/32 Push-in	
F11-21-74		1/8 NPT (F)	
F11-21-76	5/32 Push-in	1/4 Push-in	
F11-21-77		5/32 Push-in	

● Refer to page 18 for **Product Number Diagram**

Product Information

3-Way Normally Closed

	Part Number	Input	Output
Push Button	A11-30-14	1/8	1/8 NPT (F)
	A11-30-16	NPT (M)	1/4 Push-in
	A11-30-17		5/32 Push-in
	A11-30-44	1/8	1/8 NPT (F)
	A11-30-46	NPT (F)	1/4 Push-in
	A11-30-47		5/32 Push-in
	A11-30-64		1/8 NPT (F)
	A11-30-66	1/4 Push-in	1/4 Push-in
	A11-30-67		5/32 Push-in
	A11-30-74		1/8 NPT (F)
A11-30-76	5/32 Push-in	1/4 Push-in	
A11-30-77		5/32 Push-in	
Detented Toggle	H11-30-14	1/8	1/8 NPT (F)
	H11-30-16	NPT (M)	1/4 Push-in
	H11-30-17		5/32 Push-in
	H11-30-44	1/8	1/8 NPT (F)
	H11-30-46	NPT (F)	1/4 Push-in
	H11-30-47		5/32 Push-in
	H11-30-64		1/8 NPT (F)
	H11-30-66	1/4 Push-in	1/4 Push-in
	H11-30-67		5/32 Push-in
	H11-30-74		1/8 NPT (F)
H11-30-76	5/32 Push-in	1/4 Push-in	
H11-30-77		5/32 Push-in	
Momentary Toggle	F11-30-14	1/8	1/8 NPT (F)
	F11-30-16	NPT (M)	1/4 Push-in
	F11-30-17		5/32 Push-in
	F11-30-44	1/8	1/8 NPT (F)
	F11-30-46	NPT (F)	1/4 Push-in
	F11-30-47		5/32 Push-in
	F11-30-64		1/8 NPT (F)
	F11-30-66	1/4 Push-in	1/4 Push-in
	F11-30-67		5/32 Push-in
	F11-30-74		1/8 NPT (F)
F11-30-76	5/32 Push-in	1/4 Push-in	
F11-30-77		5/32 Push-in	

3-Way Normally Open

	Part Number	Input	Output
Push Button	A11-31-14	1/8	1/8 NPT (F)
	A11-31-16	NPT (M)	1/4 Push-in
	A11-31-17		5/32 Push-in
	A11-31-44	1/8	1/8 NPT (F)
	A11-31-46	NPT (F)	1/4 Push-in
	A11-31-47		5/32 Push-in
	A11-31-64		1/8 NPT (F)
	A11-31-66	1/4 Push-in	1/4 Push-in
	A11-31-67		5/32 Push-in
	A11-31-74		1/8 NPT (F)
A11-31-76	5/32 Push-in	1/4 Push-in	
A11-31-77		5/32 Push-in	
Detented Toggle	H11-31-14	1/8	1/8 NPT (F)
	H11-31-16	NPT (M)	1/4 Push-in
	H11-31-17		5/32 Push-in
	H11-31-44	1/8	1/8 NPT (F)
	H11-31-46	NPT (F)	1/4 Push-in
	H11-31-47		5/32 Push-in
	H11-31-64		1/8 NPT (F)
	H11-31-66	1/4 Push-in	1/4 Push-in
	H11-31-67		5/32 Push-in
	H11-31-74		1/8 NPT (F)
H11-31-76	5/32 Push-in	1/4 Push-in	
H11-31-77		5/32 Push-in	
Momentary Toggle	F11-31-14	1/8	1/8 NPT (F)
	F11-31-16	NPT (M)	1/4 Push-in
	F11-31-17		5/32 Push-in
	F11-31-44	1/8	1/8 NPT (F)
	F11-31-46	NPT (F)	1/4 Push-in
	F11-31-47		5/32 Push-in
	F11-31-64		1/8 NPT (F)
	F11-31-66	1/4 Push-in	1/4 Push-in
	F11-31-67		5/32 Push-in
	F11-31-74		1/8 NPT (F)
F11-31-76	5/32 Push-in	1/4 Push-in	
F11-31-77		5/32 Push-in	



Ordering Information

- To order standard product use part number listing.
- To order metal push button- use an "M" as the second character to indicate metal.
- Optional seals available- contact factory.
- Nylon toggles and push buttons are available in seven colors with black as standard. To order colored actuator specify the color, by code, as a "-code#" suffix following the part number (see color code chart page 91).



The standard "11" Series valve output port swivels to accommodate critical alignment

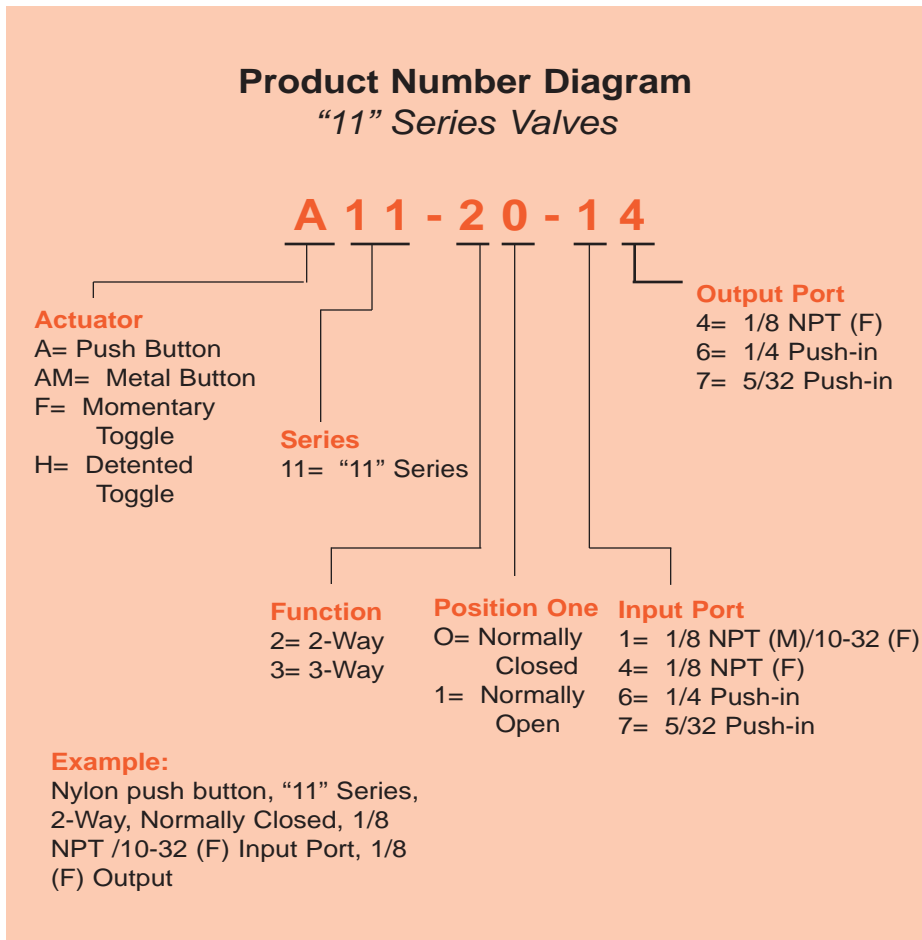

System 11 is a method of consolidating 2 to 10 components with a common pressure source.

This custom product is shown with "11" Series valves- see page 82 for additional information.



Push Button Actuator

Toggle Actuator

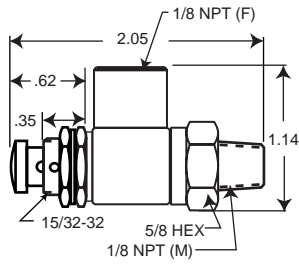

"-14" Porting

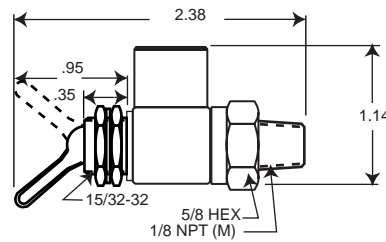

"-14" Porting

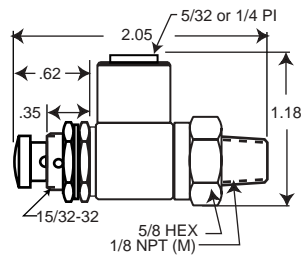

"-16" Porting
"-17" Porting

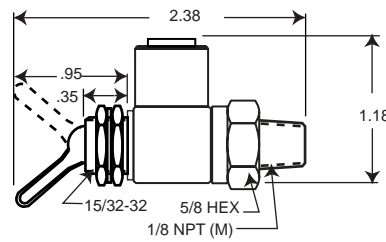

"-16" Porting
"-17" Porting

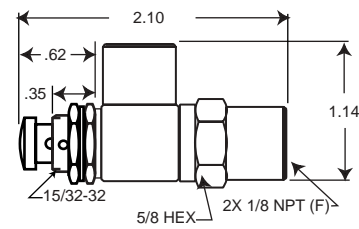

"-44" Porting

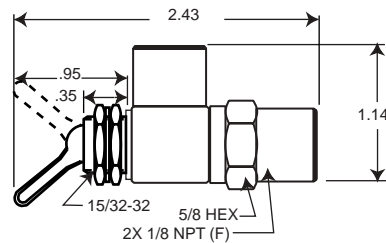

"-44" Porting

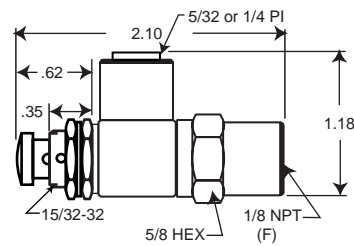

"-46" Porting
"-47" Porting

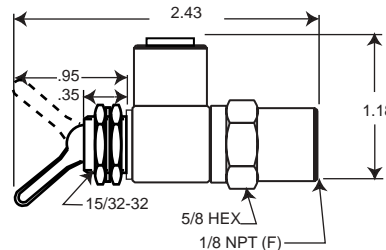

"-46" Porting
"-47" Porting

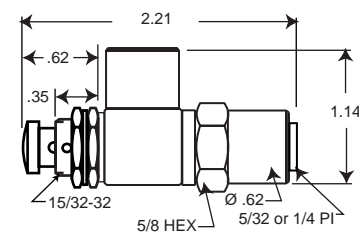

"-64" Porting
"-74" Porting

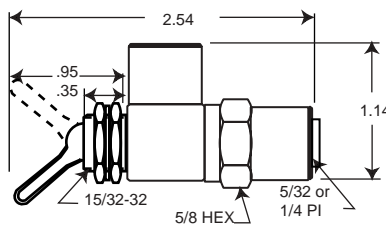

"-64" Porting
"-74" Porting

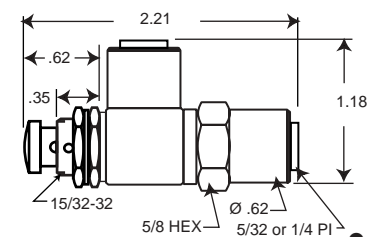

"-66" Porting
"-67" Porting
"-76" Porting
"-77" Porting

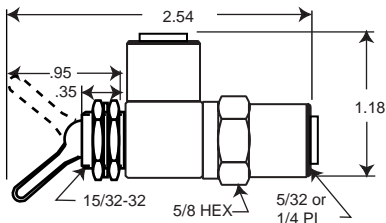

"-66" Porting
"-67" Porting
"-76" Porting
"-77" Porting

● When design makes a dimension critical- contact factory for confirmation. All dimensions shown subject to change without notice.

Features

- Single stem design
- Compact size
- Four input options
- Numerous porting configurations
- Fully ported design offers plumbing versatility
- Vacuum applications to 26" Hg



2 & 3-Way Valves "200" & "300" Series

The "200" & "300" Series valves feature miniature size and a single stem design. The "200" Series valve features 1/16 barbed porting and is ideal for use as a pilot service device. The "300" Series is available with five porting configurations offering the following:

10-32 (F) Input/Output: Ideal for use as a pilot actuating device and for basic on/off functions

Rear Ported: Streamlined profile with side-by-side porting for use in space constrained applications

1/8 NPT (M) Input: Ideal for direct mounting in a manifold or other machine member

Cartridge: Ideal for use in manifold systems and custom applications where space is limited

10-32 (F) Fully ported: Threaded exhaust port can be used in applications to direct and capture exhaust flow- see page 32 for alternative plumbing options

Performance Data

Temperature Range	Operating Pressure
-20° to 160° F	26" Hg to 125 psi

Product	C _v		Flow Rate (scfm)				Fill Time sec/ in ³ 0-90 psi	Exhaust Time sec/ in ³ 100-10 psi
	Port 1-2	Port 2-3	Port 1-2		Port 2-3			
			50 psi	125 psi	50 psi	125 psi		
"200" Series Barbed	.02	N/A	.9	2.1	N/A	N/A	.14	.20
"300" Series 10-32 (F) Input/output	.20	N/A	7.2	15.5	N/A	N/A	.02	.04
"300" Series 10-32 (F) Fully ported	.22	.17	7.0	14.8	5.5	11.8	.02	.04

- 2-Way valves ideal for use in liquid applications compatible with materials of construction

C_v per ANSI / (NFPA) T3.21.3

Actuation Force

Actuator Style	"200" Series Barbed		"300" Series 10-32 input		"300" Series Fully ported 10-32 (F)	
	50 psi	125 psi	50 psi	125 psi	50 psi	125 psi
Toggle	6 oz	11 oz	6 oz	11 oz	6 oz	11 oz
Ball	29 oz	51 oz	29 oz	51 oz	29 oz	51 oz
Push Button	29 oz	51 oz	29 oz	51 oz	29 oz	51 oz
Integral Air Pilot	-	-	-	-	30 psi	40 psi

Materials

Brass/ Electroless Nickel, Aluminum/ Anodize, Stainless Steel, Buna-N (optional seals available- contact factory)

“300” Series Cut-away 3-Way Normally Closed

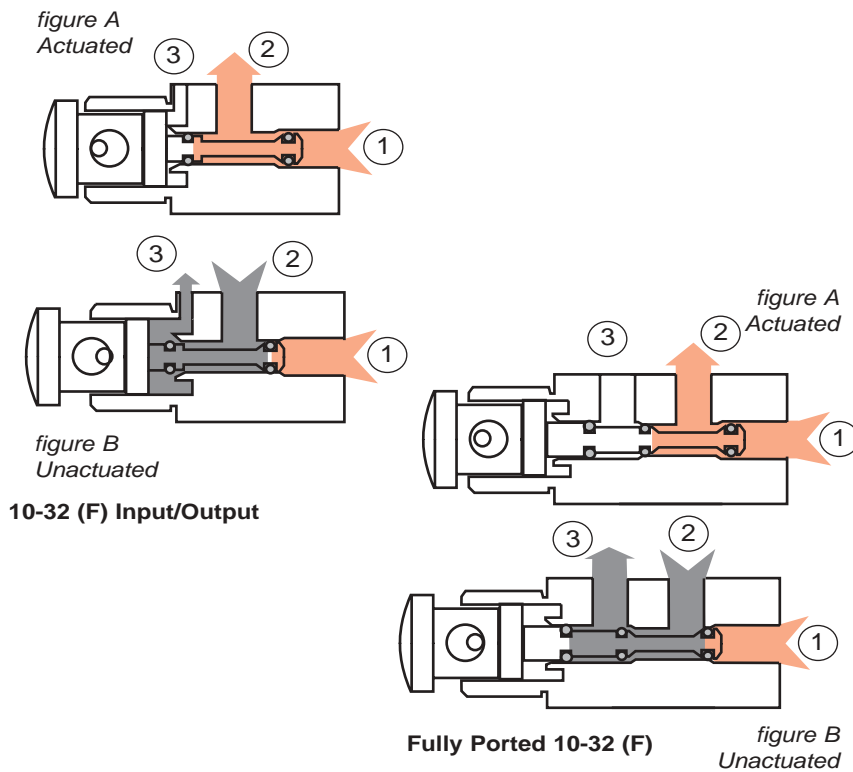

Function

In the actuated position (figure A) air flows through port 1 travels around the lower O-ring and flows out port 2- the upper O-ring seals the passage preventing exhaust flow out of the valve.

In the unactuated position (figure B) the lower O-ring seals the flow at port 1, allowing flow to enter port 2 travel around the upper seal and exhaust to atmosphere through port 3.

The **10-32 (F) fully ported** valve allows the capture and removal of exhaust flow. (See **Plumbing Options for Fully Ported Valves** on page 32 for alternative plumbing methods.)

Port Options

Valve	Input 1	Output 2	Exhaust
Barbed	062 Barb	062 Barb	non-threaded
10-32 (F) Input/Output	10-32 (F)	10-32 (F)	non-threaded
Rear Ported	10-32 (F)	10-32 (F)	non-threaded
1/8 NPT Input	1/8 NPT (M)	10-32 (F)	non-threaded
*Cartridge	non-threaded	non-threaded	non-threaded
10-32 (F) Fully Ported	10-32 (F)	10-32 (F)	10-32 (F)

*Cartridge valve mounting drawing can be found on page 30

“200” Series Flow Chart

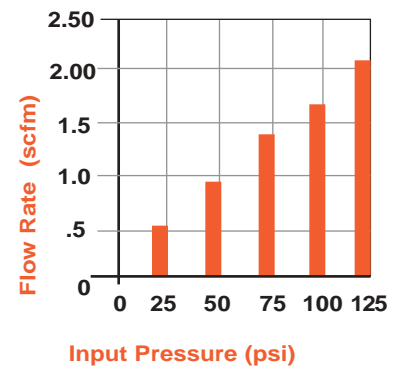

“300” Series Flow Chart

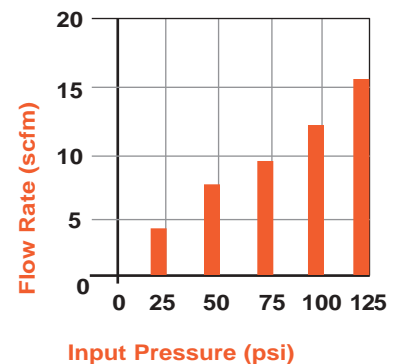

Mounting Method

Panel	Surface
Nominal mounting hole dimension 31/64"	MB-1 or MB-1F Mounting Bracket

(2) nuts and (1) lockwasher provided



Ordering Information

- To order standard product use part number listing.
- With Ethylene Propylene O-ring seal, change the "CO" in the part number to "CE".
- With Viton® O-ring seal, change the "CO" in the part number to "CV".
- Nylon toggle and push buttons are available in seven colors with black as standard. To order colored actuators specify the color, by code, as a "-code#" suffix following the part number (see color code chart page 91).

Viton® is a registered trademark of Dupont Dow Elastomers

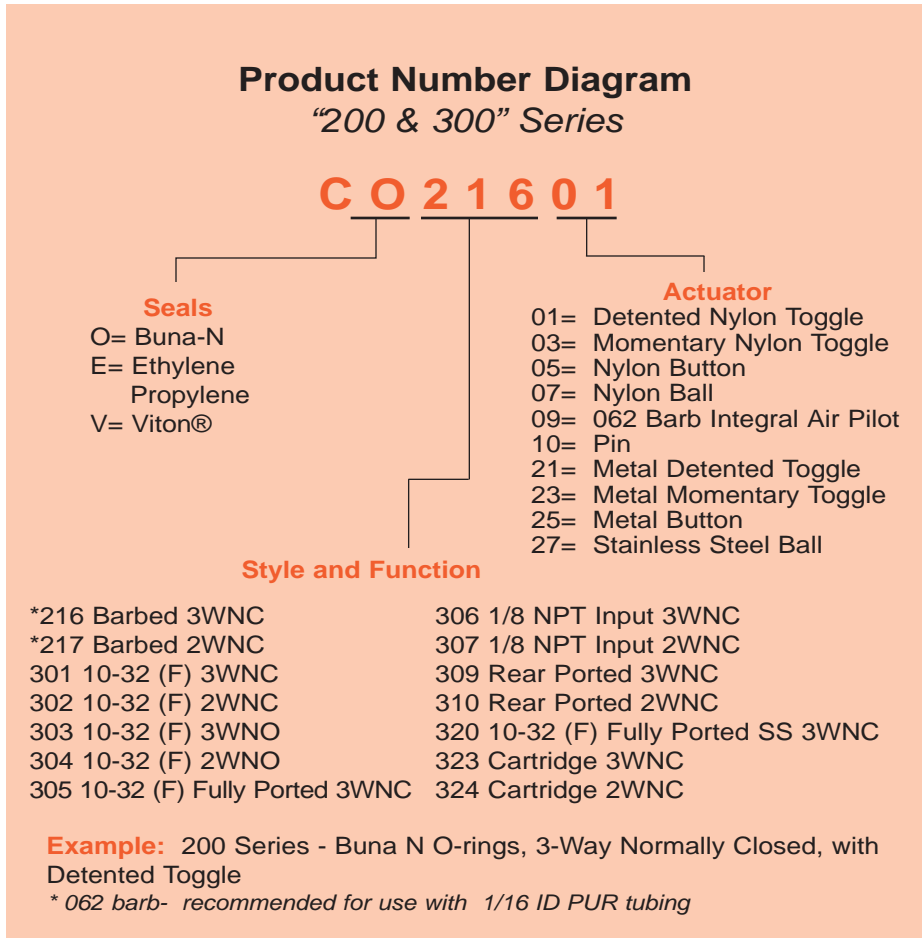

Stainless Steel 10-32 Fully Ported valve with **M5** threads available- contact factory

Product Information

"200" Series Barbed Valve

Part Number	Operator
3-Way Normally Closed	
C021601	Toggle Detented
C021603	Toggle Momentary
C021605	Nylon Button
C021607	Nylon Ball
C021621	Metal Toggle Detented
C021623	Metal Toggle Momentary
C021625	Metal Button
C021627	Stainless Steel Ball
2-Way Normally Closed	
C021701	Toggle Detented
C021703	Toggle Momentary
C021705	Nylon Button
C021707	Nylon Ball
C021721	Metal Toggle Detented
C021723	Metal Toggle Momentary
C021725	Metal Button
C021727	Stainless Steel Ball

Product Information

"300" Series 10-32 Input

Part Number	Input
3-Way Normally Closed	
C030101	Toggle Detented
C030103	Toggle Momentary
C030105	Nylon Button
C030107	Nylon Ball
C030109	062 Barb Integral Air Pilot
C030121	Metal Toggle Detented
C030123	Metal Toggle Momentary
C030125	Metal Button
C030127	Stainless Steel Ball
2-Way Normally Closed	
C030201	Toggle Detented
C030203	Toggle Momentary
C030205	Nylon Button
C030207	Nylon Ball
C030209	062 Barb Integral Air Pilot
C030221	Metal Toggle Detented
C030223	Metal Toggle Momentary
C030225	Metal Button
C030227	Stainless Steel Ball
3-Way Normally Open	
C030301	Toggle Detented
C030303	Toggle Momentary
C030305	Nylon Button
C030307	Nylon Ball
C030321	Metal Toggle Detented
C030323	Metal Toggle Momentary
C030325	Metal Button
C030327	Stainless Steel Ball
2-Way Normally Open	
C030401	Toggle Detented
C030403	Toggle Momentary
C030405	Nylon Button
C030407	Nylon Ball
C030421	Metal Toggle Detented
C030423	Metal Toggle Momentary
C030425	Metal Button
C030427	Stainless Steel Ball

"300" Series Rear Ported

Part Number	Input
3-Way Normally Closed	
C030901	Toggle Detented
C030903	Toggle Momentary
C030905	Nylon Button
C030907	Nylon Ball
C030921	Metal Toggle Detented
C030923	Metal Toggle Momentary
C030925	Metal Button
C030927	Stainless Steel Ball
2-Way Normally Closed	
C031001	Toggle Detented
C031003	Toggle Momentary
C031005	Nylon Button
C031007	Nylon Ball
C031021	Metal Toggle Detented
C031023	Metal Toggle Momentary
C031025	Metal Button
C031027	Stainless Steel Ball

"300" Series 1/8 NPT (M) Input

Part Number	Input
3-Way Normally Closed	
C030601	Toggle Detented
C030603	Toggle Momentary
C030605	Nylon Button
C030607	Nylon Ball
C030621	Metal Toggle Detented
C030623	Metal Toggle Momentary
C030625	Metal Button
C030627	Stainless Steel Ball
2-Way Normally Closed	
C030701	Toggle Detented
C030703	Toggle Momentary
C030705	Nylon Button
C030707	Nylon Ball
C030721	Metal Toggle Detented
C030723	Metal Toggle Momentary
C030725	Metal Button
C030727	Stainless Steel Ball

"300" Series Cartridge

Part Number	Input
3-Way Normally Closed	
C032301	Toggle Detented
C032303	Toggle Momentary
C032305	Nylon Button
C032307	Nylon Ball
C032321	Metal Toggle Detented
C032323	Metal Toggle Momentary
C032325	Metal Button
C032327	Stainless Steel Ball
2-Way Normally Closed	
C032401	Toggle Detented
C032403	Toggle Momentary
C032405	Nylon Button
C032407	Nylon Ball
C032421	Metal Toggle Detented
C032423	Metal Toggle Momentary
C032425	Metal Button
C032427	Stainless Steel Ball

"300" Series 10-32 Fully Ported

Part Number	Input
3-Way Normally Closed	
C030501	Toggle Detented
C030503	Toggle Momentary
C030505	Nylon Button
C030507	Nylon Ball
C030509	062 Barb Integral Air Pilot
C030510	Pin
C030521	Metal Toggle Detented
C030523	Metal Toggle Momentary
C030525	Metal Button
C030527	Stainless Steel Ball

\$ "300" Series 10-32 Fully Ported Stainless Steel

Part Number	Input
3-Way Normally Closed	
C032001	Toggle Detented
C032003	Toggle Momentary
C032005	Nylon Button
C032007	Nylon Ball
C032021	Metal Toggle Detented
C032023	Metal Toggle Momentary
C032025	Metal Button
C032027	Stainless Steel Ball



Look for this symbol next to the part number listing to easily locate stainless steel products.

Barbed Ports

10-32 (F) Input

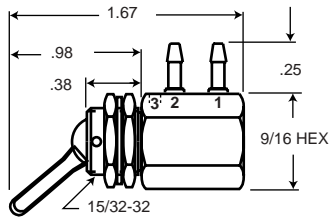

C021601
C021603
C021701
C021703

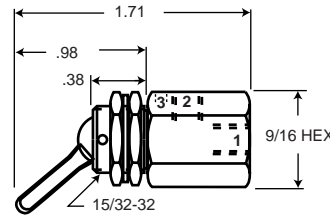

C030101 C030103
C030201 C030203
C030301 C030303
C030401 C030403

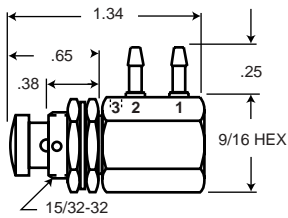

C021605
C021625
C021705
C021725

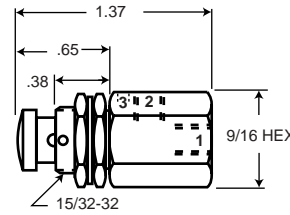

C030105 C030125
C030205 C030225
C030305 C030325
C030405 C030425

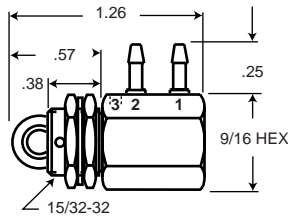

C021607
C021627
C021707
C021727

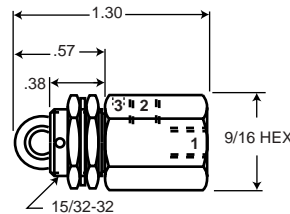

C030107 C030127
C030207 C030227
C030307 C030327
C030407 C030427

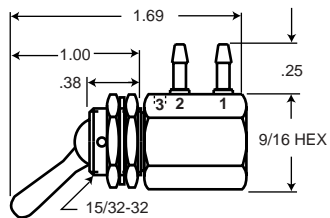

C021621
C021623
C021721
C021723

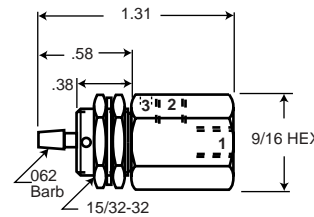

C030109
C030209

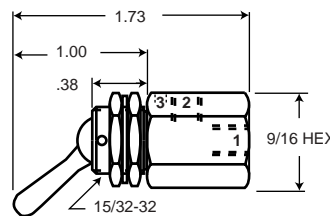

C030121 C030123
C030221 C030223
C030321 C030323
C030421 C030423

● Refer to **Product Number Diagram** for part number description

● Port 3 is for 3-Way products only

● When design makes a dimension critical- contact factory for confirmation. All dimensions shown subject to change without notice.

Rear Ported

1/8 NPT Input

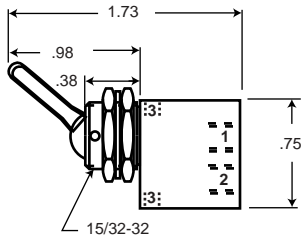

C030901
C030903
C031001
C031003

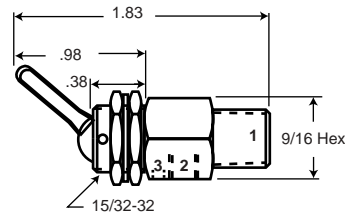

C030601
C030603
C030701
C030703

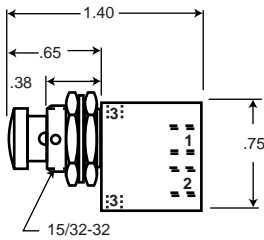

C030905
C030925
C031005
C031025

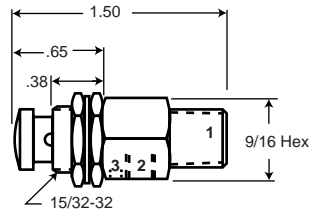

C030605
C030625
C030705
C030725

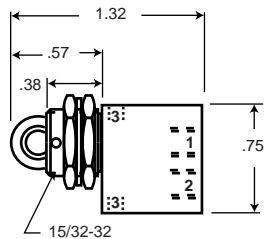

C030907
C030927
C031007
C031027

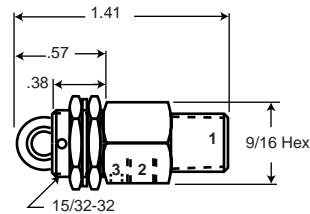

C030607
C030627
C030707
C030727

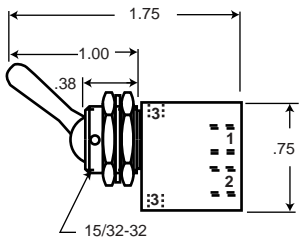

C030921
C030923
C031021
C031023

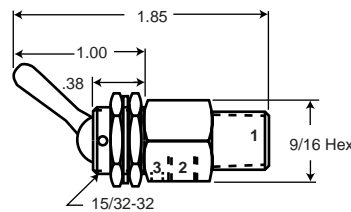

C030621
C030623
C030721
C030723

- Refer to **Product Number Diagram** for part number description

- Port 3 is for 3-Way products only

Cartridge

10-32 (F) Fully Ported

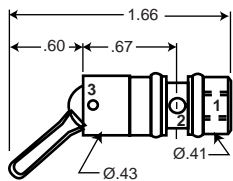

C032301
C032303
C032401
C032403

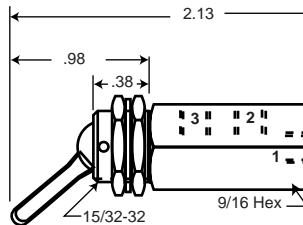

C030501
C030503

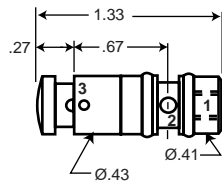

C032305
C032325
C032405
C032425

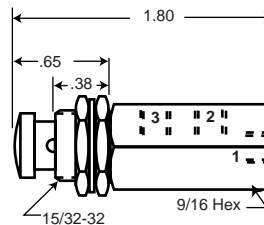

C030505
C030525

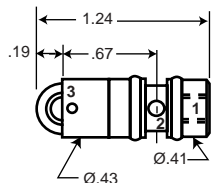

C032307
C032327
C032407
C032427

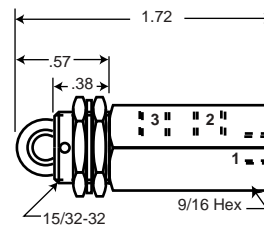

C030507
C030527

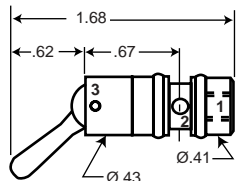

C032321
C032323
C032421
C032423

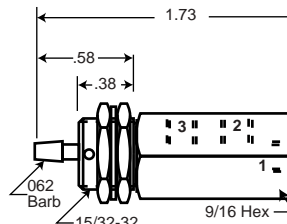

C030509

Preferred Method

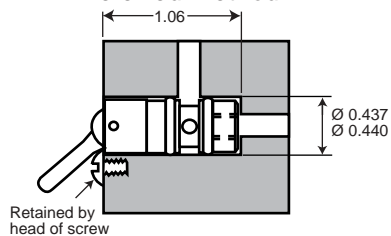

Mounting
Options

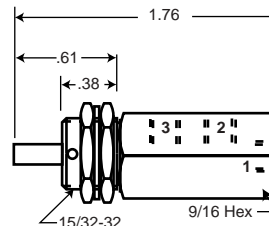

C030510

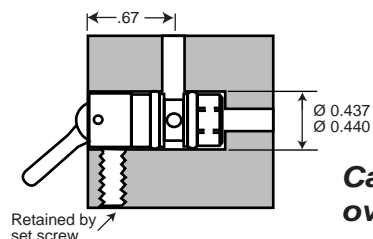

**Caution- do NOT
over torque
retention screw**

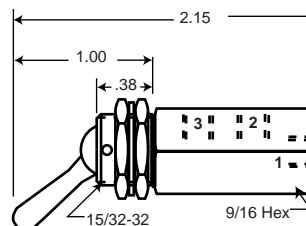

C030521
C030523

10-32 (F) Fully Ported

Stainless Steel

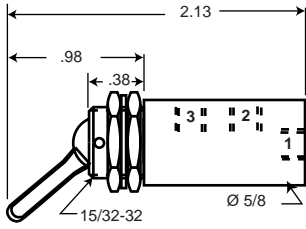

☛ C032001

☛ C032003

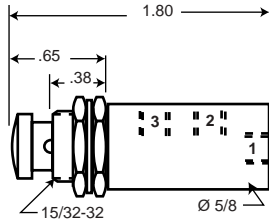

☛ C032005

☛ C032025

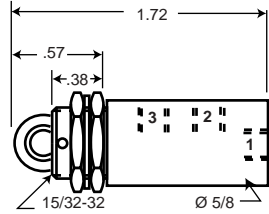

☛ C032007

☛ C032027

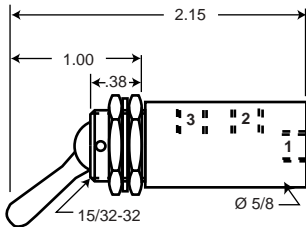

☛ C032021

☛ C032023

● Refer to **Product Number Diagram** for part number description

● Port 3 is for 3-Way products only

● When design makes a dimension critical- contact factory for confirmation. All dimensions shown subject to change without notice.

Features

- Compact size (1.5" OAL)
- 4 Porting configurations
- High flow
- Single stem design
- Plumbing versatility
- Mounting versatility
- Vacuum applications to 26" Hg



2 & 3-Way Valves "400" Series

The "400" Series valve is available in 2-Way or 3-Way Normally Closed, Standard, Side and Rear Ported (3-Way exhausts to atmosphere) or as a 3-Way Normally Closed Fully Ported valve.

The **1/8 NPT (F) Standard Ported** valve features 1/8 NPT female bottom input and side output ports. The exhaust port is non-threaded and is located opposite the output port.

The **1/8 NPT (F) Rear Ported** valve features parallel bottom input and output porting with a streamlined design ideal for use in space constrained applications.

The **1/8 NPT (F) Fully Ported** and **1/8 NPT (F) Side Ported** valves feature a threaded exhaust port that can be used in applications to direct and capture exhaust flow.

Performance Data

Temperature Range	Operating Pressure	C _v	Flow Rate (scfm)		Fill Time sec/ in ³ 0-90 psi	Exhaust Time sec/ in ³ 100-10 psi
			50 psi	125 psi		
-20° to 160° F	26" Hg to 125 psi	.28	9.7	21.5	.01	.02

- Flow information supplied for flow path 1-2.

Plumbing Options for Fully Ported Valves

Function	Port 1	Port 2	Port 3
3-Way N.C.	Input	Output	Exhaust
3-Way N.O.	Exhaust	Output	Input
2-Way Diverter	Output	Input	Output
2-Way Selector	Input	Output	Input

Note: Alternative plumbing methods for fully ported valves **only**.

C_v per ANSI / (NFPA) T3.21.3

Materials

Aluminum/ Anodize, Brass/ Electroless Nickel, Acetal, Stainless Steel, Nylon, Brass, Buna-N (optional seals available - contact factory)

“400” Series Cut-away 3-Way Normally Closed

figure A
Actuated

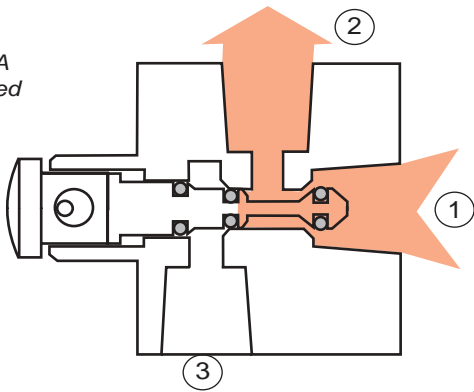
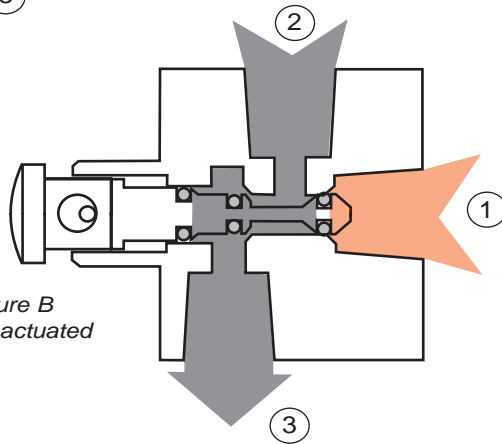

figure B
Unactuated



Function

In the actuated position (figure A) air flows through port 1 travels around the lower O-ring and out port 2. The center O-ring seals the passage blocking exhaust flow.

In the unactuated position (figure B) the lower O-ring seals port 1 allowing return flow to enter port 2, travel around the center seal and exhaust to atmosphere through port 3.

Port Options

Definition	1/8 NPT Standard	1/8 NPT Rear Ported	1/8 NPT Fully Ported	1/8 NPT Side Ported
Port 1 Input	1/8 NPT (F)	1/8 NPT (F)	1/8 NPT (F)	1/8 NPT (F)
Port 2 Output	1/8 NPT (F)	1/8 NPT (F)	1/8 NPT (F)	1/8 NPT (F)
Port 3 Exhaust	*non-threaded	*non-threaded	1/8 NPT (F)	1/8 NPT (F)

* Exhausts to atmosphere

“400: Series Flow Rate

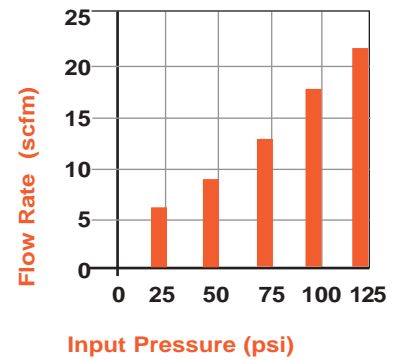

“400” Series 1/8 NPT
Side Ported Valves

Actuation Force

Actuator Style	50 psi	125 psi
Toggle	13 oz	19 oz
Ball	3 1/2 lbs	5 1/2 lbs
Push Button	3 1/2 lbs	5 1/2 lbs

Mounting Method

Panel	Surface
Nominal mounting hole dimension 31/64"	(2) .20 diam. thru holes

(2) nuts and (1) lockwasher provided

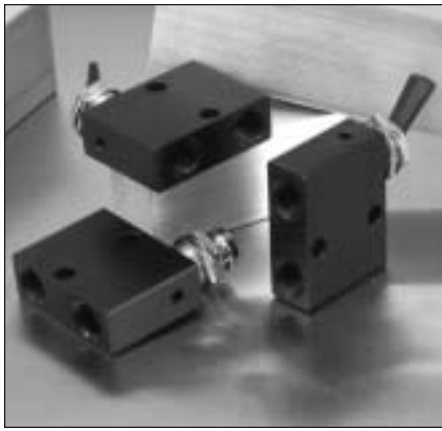

The 1/8 NPT Rear Ported valve features parallel porting in a compact design

Product Information "400" Series

1/8 NPT Standard

Part Number	Operator
3-Way Normally Closed	
C040101	Toggle Detented
C040103	Toggle Momentary
C040105	Nylon Button
C040107	Nylon Ball
C040121	Metal Toggle Detented
C040123	Metal Toggle Momentary
C040125	Metal Button
C040127	Stainless Steel Ball
2-Way Normally Closed	
C040201	Toggle Detented
C040203	Toggle Momentary
C040205	Nylon Button
C040207	Nylon Ball
C040221	Metal Toggle Detented
C040223	Metal Toggle Momentary
C040225	Metal Button
C040227	Stainless Steel Ball

1/8 NPT Rear Ported

Part Number	Operator
3-Way Normally Closed	
C040901	Toggle Detented
C040903	Toggle Momentary
C040905	Nylon Button
C040907	Nylon Ball
C040921	Metal Toggle Detented
C040923	Metal Toggle Momentary
C040925	Metal Button
C040927	Stainless Steel Ball
2-Way Normally Closed	
C041001	Toggle Detented
C041003	Toggle Momentary
C041005	Nylon Button
C041007	Nylon Ball
C041021	Metal Toggle Detented
C041023	Metal Toggle Momentary
C041025	Metal Button
C041027	Stainless Steel Ball

1/8 NPT Side Ported

Part Number	Operator
3-Way Normally Closed	
C040401	Toggle Detented
C040403	Toggle Momentary
C040405	Nylon Button
C040407	Nylon Ball
C040421	Metal Toggle Detented
C040423	Metal Toggle Momentary
C040425	Metal Button
C040427	Stainless Steel Ball

1/8 NPT Fully Ported

Part Number	Operator
3-Way Normally Closed	
C040501	Toggle Detented
C040503	Toggle Momentary
C040505	Nylon Button
C040507	Nylon Ball
C040521	Metal Toggle Detented
C040523	Metal Toggle Momentary
C040525	Metal Button
C040527	Stainless Steel Ball

Product Number Diagram "400" Series

C O 4 0 1 0 1

Seals

O= Buna-N
E= Ethylene
Propylene
V= Viton®

Style and Function

401= Standard 3WNC
402= Standard 2WNC
404= Side Ported 3WNC
405= Fully Ported 3WNC
409= Rear Ported 3WNC
410= Rear Ported 2WNC

Actuator

01= Detented Nylon Toggle
03= Momentary Nylon Toggle
05= Nylon Button
07= Nylon Ball
21= Metal Detented Toggle
23= Metal Momentary Toggle
25= Metal Button
27= Stainless Steel Ball

Example: 400 Series - Buna N O-rings, Standard 3-Way Normally Closed, with Detented Nylon Toggle



● **Push-in fittings available** for 1/8", 5/32" and 1/4" OD tubing. Product information can be found on page 92 and 117.

Valves
"400" Series

Ordering Information

- To order standard product use part number listing.
- With Ethylene Propylene O-ring seal, change the "CO" in the part number to "CE".
- With Viton® O-ring seal, change the "CO" in the part number to "CV".
- Nylon toggle and push buttons are available in seven colors with black as standard. To order colored actuators specify the color, by code, as a "-code" suffix following the part number (see color code chart page 91).

The 1/8 NPT Side Ported Valve is able to accommodate reverse flow applications- contact factory

1/8 NPT Standard

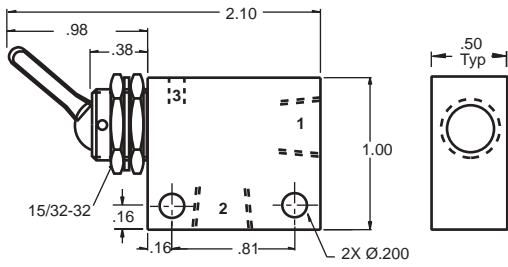

C040101
C040103
C040201
C040203

1/8 NPT Rear Ported

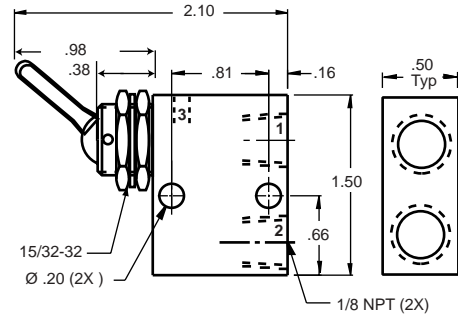

C040901
C040903
C041001
C041003

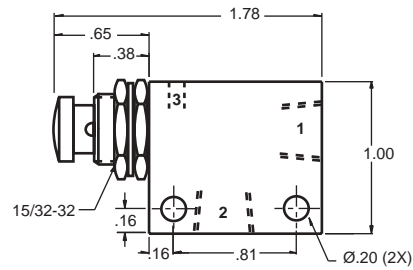

C040105
C040125
C040205
C040225

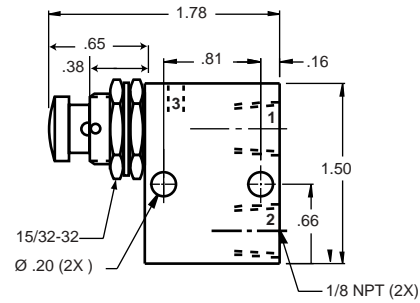

C040905
C040925
C041005
C041025

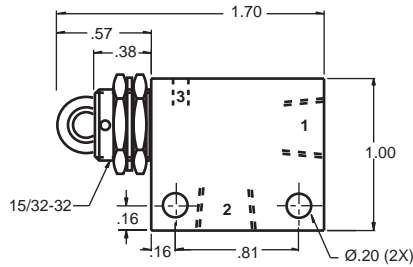

C040107
C040127
C040207
C040227

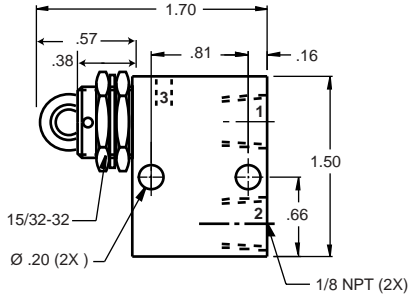

C040907
C040927
C041007
C041027

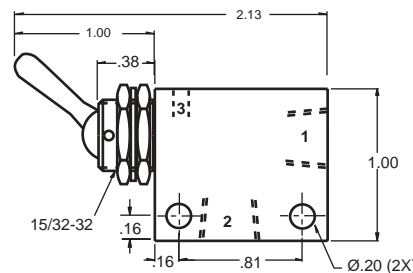

C040121
C040123
C040221
C040223

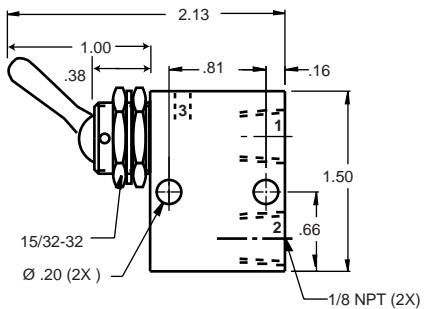

C040921
C040923
C041021
C041023

- Port 3 is for 3-Way products only
- When design makes a dimension critical- contact factory for confirmation. All dimensions shown subject to change without notice.

1/8 NPT Fully Ported

1/8 NPT Side Ported

Valves
"400" Series

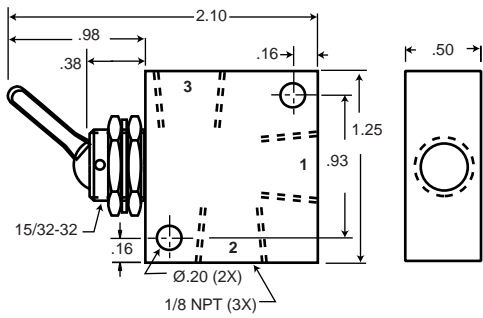

C040501
C040503

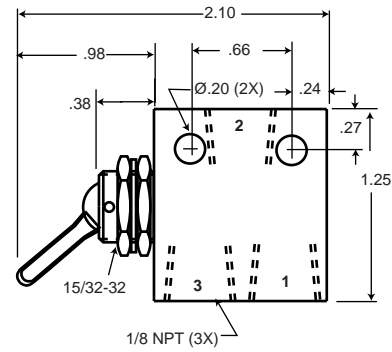

C040401
C040403

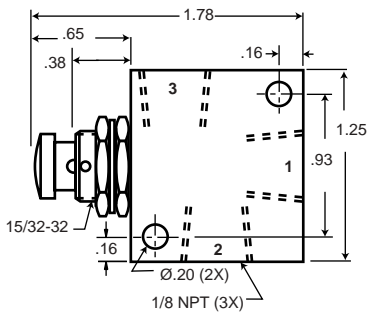

C040505
C040525

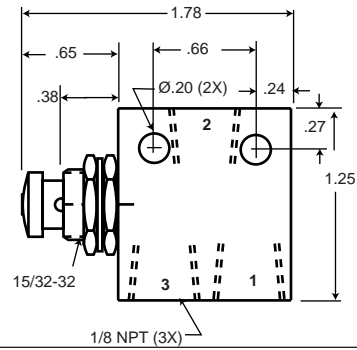

C040405
C040425

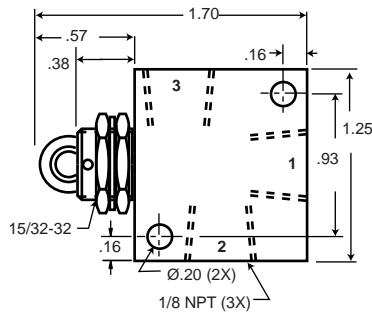

C040507
C040527

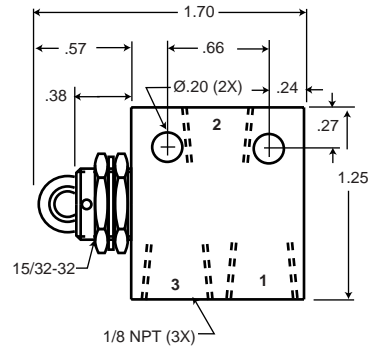

C040407
C040427

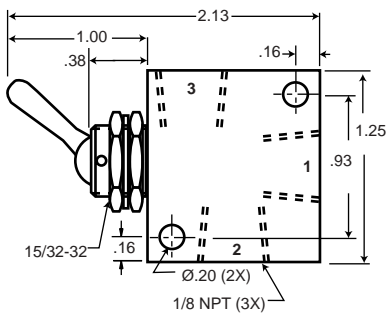

C040521
C040523

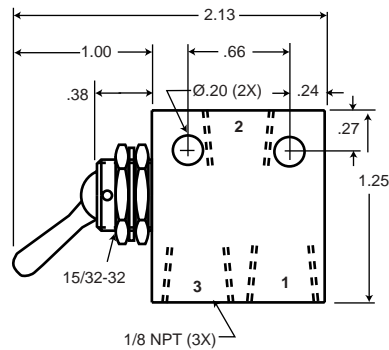

C040421
C040423

- Port 3 is for 3-Way products only
- When design makes a dimension critical- contact factory for confirmation. All dimensions shown subject to change without notice.

Features

- Maximum flow rate for miniature valve line
- Dual function
- Mounting versatility
- Push-to-connect fittings available
- Available with 1/8 NPT or 1/4 NPT porting



2 & 3-Way Valves 3-Position Toggle

The 3-Position Toggle Valve offers the highest flow rate of the Pneumadyne valve line. This dual function product contains two valves in one body with a common input and common exhaust. The 2-Way **high flow valves** (C042803 & C042903) feature a red anodized body for easy identification.

When the toggle is centered in the 2-Way configuration all ports are blocked, in the 3-Way configuration both output ports are open to exhaust.

Port Options

Port 1 Input	<ul style="list-style-type: none"> ● 1/8 NPT (F) ● 1/4 NPT (F)
Port 2 Output	<ul style="list-style-type: none"> ● 1/8 NPT (F) ● 1/4 NPT (F)
Exhaust	<i>non-threaded (3-Way exhausts to atmosphere)</i>

Mounting Method

Panel	Surface
Nominal hole dimension 25/32"	(2) .20 diam. thru holes

(2) nuts provided

Performance Data

Product	Flow Path	Temp Range	Operating Pressure	C _v	Flow Rate (scfm)		Fill Time sec/ in ³ 0-90 psi	Exhaust Time sec/ in ³ 100-10 psi
					50 psi	125 psi		
C04250* C04260*	1-2	-20° to 160° F	0 to 125 psi	.47	19	41	.006	.030
C042803 C042903	1-2/ 2-1		0 to 150 psi	.70	27	57	.005	.009

Caution: ONLY High Flow version can be plumbed with input at Port 2.

C_v per ANSI / (NFPA) T3.21.3

Actuation Force

Product	2-Way Valve		3-Way Valve	
	50 psi	125 psi	50 psi	125 psi
C04250* & C04260*	72 oz	7-1/2 lbs	72 oz	7-1/2 lbs
C042803 & C042903	64 oz	84 oz	N/A	N/A

Materials

Aluminum/ Anodize, Brass/ Electroless Nickel, Stainless Steel, Buna-N (other seals available contact factory)

Application Idea

Dual Function Use:

2-Way High Flow C042803 & C042903 Flow Path 2-1

- Inflate and deflate an air bag lift device (*shown at right*)
- Dual pressure selector

3-Way Standard

- #### C04250* Flow Path 1-2 (*not shown*)
- Can be used in 4-way applications (open center) to extend and retract cylinders
 - Pneumatic pilot control on a hydraulic valve

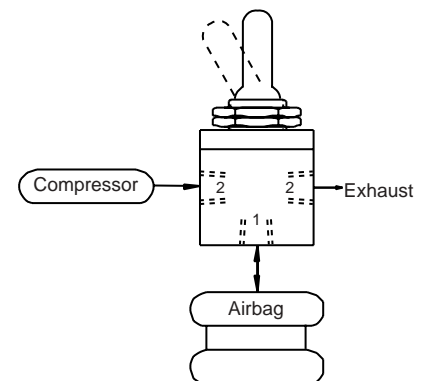

3 Position Toggle Cut-away

3-Way Normally Closed

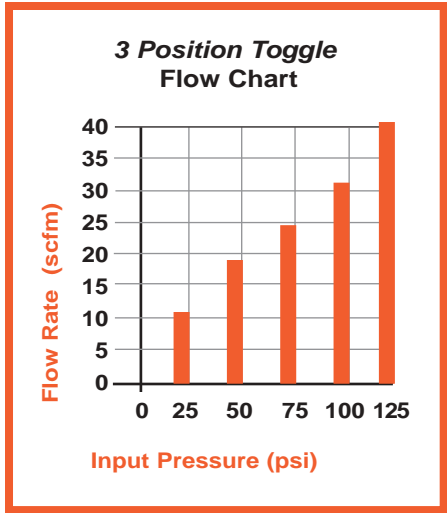
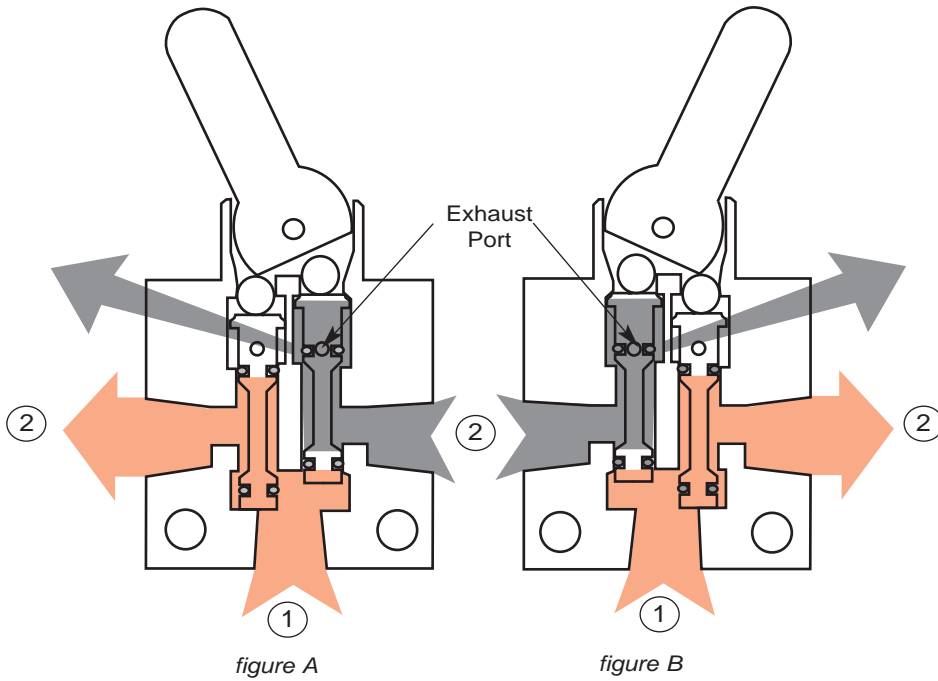

Valves
"400" Series

Product Information

"400" Series 3-Position Toggle Valve

Part Number	Porting	Actuation
2-Way		
C042601	1/8 NPT	Det/ Det
C042602	1/8 NPT	Det/ Mom
C042603	1/8 NPT	Mom/ Mom
2-Way High Flow		
C042803	1/8 NPT	Mom/ Mom
C042903	1/4 NPT	Mom/ Mom
3-Way		
C042501	1/8 NPT	Det/ Det
C042502	1/8 NPT	Det/ Mom
C042503	1/8 NPT	Mom/ Mom

3-Position Toggle

1/8 NPT

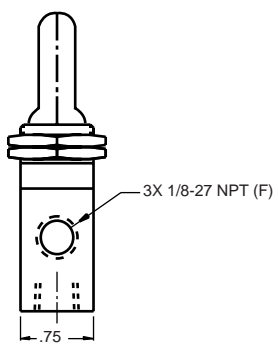
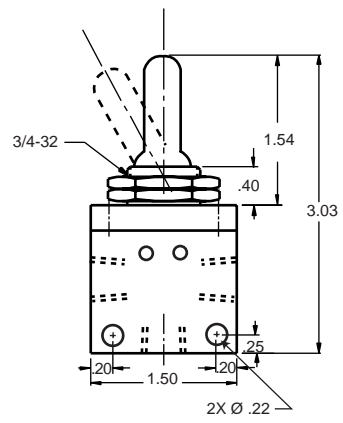

1/4 NPT

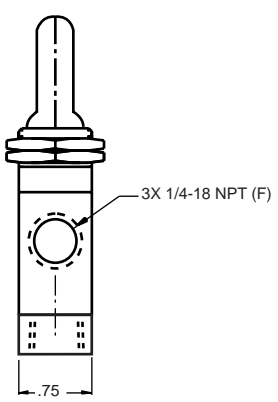
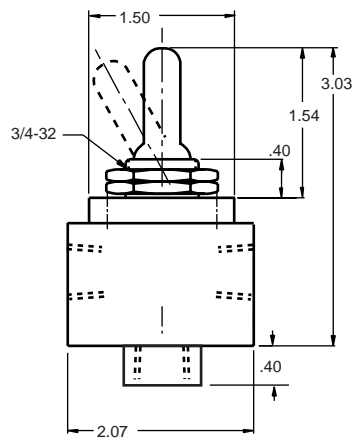

1/8", 5/32", and 1/4"
push-to-connect fittings
available - refer to page
92 for information

Ordering Information

- With Buna-N O-ring seal, part number listed in chart.
- With Ethylene Propylene O-ring seal, change the "CO" in the part number to "CE".
- With Viton® O-ring seal, change the "CO" in the part number to "CV".