

PRODUCT APPRECIATION MANUAL



山东小鸭冷链有限公司

SHANDONG XIAOYA REFRIGERATION CO., LTD.

地址: 济南市工业南路51号小鸭工业园 Add: NO.51, South Industrial Road, Jinan China.

Tel: 0086-531-67682185

Mobile / WeChat / WhatsApp: 0086-15865289539

Email: sales@xiaoyashowcase.com sales@littleduckshowcase.com

http://www.xiaoyashowcase.com http://www.littleduckshowcase.com

小鸭 展示柜

LITTLE DUCK SHOWCASE



质量创新时代·科技引领未来

QUALITY OPENS AN INNOVATIVE ERA
TECHNOLOGY CONDUCTS THE BRIGHT FUTURE





目录

CATALOG

壁式冷冻冷藏展示柜

Remote Frozen & Refrigerated
Multi-deck Display Case

- 04-E7 奥克兰/赫米特
E7 AUCKLAND / E7 HEMET
- 06-E7 马里兰/麦克林
E7 MARYLAND / E7 MCLEAN
- 08-E8 奥兰多
E8 ORLANDO
- 10-E7 亚特兰大/迈阿密
E7 ATLANTA / E7 MIAMI
- 12-E7 圣保罗
E7 ST.PAWL
- 14-E7 奥斯汀
E7 AUSTIN
- 16-E7 尤瑞克
E7 EURAKA

岛式冷冻展示柜

Remote Island Self Service
Frozen & Refrigerated Merchandiser

- 20- E7 夏威夷/华盛顿
E7 HAWAII / E7 WASHINGTON
- 22- E7 印第安纳
E7 INDIANA
- 24- E7 加利福尼亚
E7 CALIFORNIA
- 26- E8 兰辛
E8 LANSING

柜台式展示柜

Remote & Self-Contained Counter
Type Merchandiser

- 30- E6 阿拉斯加(冷柜)
E6 ALASKA (Refrigerator)
- 32- E7 维多利亚
E7 VICTORIA
- 34- E7 匹兹堡
E7 PITTSBURG
- 36- E7 加利鲜肉柜
E7 CARY
- 38- E6 阿拉斯加(干热柜)/E6 波士顿(湿热柜)
E6 ALASKA(dry heat)/E6 BOSTON(moist heat)



企业简介

山东小鸭零售设备有限公司坐落在美丽的泉城——济南，厂区位于济南高新技术开发区，是山东小鸭集团投巨资建立的零售设备研发生产基地，主要生产和销售小鸭展示柜等产品。



公司占地面积41600平方米，是目前国内规模最大的生产冷冻冷藏展示柜的厂家之一。公司采用意大利具有国际先进水平的最新技术，从意大利、瑞士、日本等国引进先进的生产设备，自动化程度高，加工精确。产品采用最新的一体化设计，具有国际一流水平，造型美观、豪华气派，是现代大型超市、连锁店、商场、便利店的理想选择。

公司采用先进的技术管理和质量管理，对产品严把质量关，先后通过ISO9001质量管理体系认证、ISO14001环境管理体系认证、OHSAS18001职业健康安全管理体系认证、欧盟CE认证等。公司从意大利、日本、德国引进先进的检验和试验设备，拥有国际一流水平的产品质量检测线和产品实验室，根据ISO9001质量管理体系的要求，制定了完善的质量考核细则，并建立、健全了科学严密的质量保证体系。目前小鸭展示柜已通过沃尔玛、华润万家、苏宁易购等国际国内零售巨头的严格审查，成功进入其卖场。公司产品在国内市场销售的同时，已销往美国、英国、法国、意大利、俄国、澳大利亚、东南亚等国家和地区。

公司以质量求生存、以科技求发展，本着以“改善现代购物环境，提高生活质量”为宗旨，以一流的产品、质量和服务为人类营造健康的购物环境做出自己的贡献。

41,600_{m²}

占地面积
Area covered



ABOUT US

Shandong Xiaoya Retail Equipment Co., Ltd. (Xiaoya Retail) is located in Jinan Hi-Tech Development Zone of Jinan, the beautiful city of Springs. As a research and manufacturing base with huge investment from Shandong Xiaoya Group, Xiaoya Retail manufactures and sells refrigerated showcases.

Xiaoya Retail covers 41600m², it is one of the largest manufacturers specialize in refrigerated display cases . It adopted the international newest and advanced technology of Italy, and imported the advanced equipment from Italy, Switzerland and Japan. All of the equipments are controlled by data and computers, and easy to be operated. The products are designed by the all-in-one design with first class technology and quality. The appearance is special and luxury. It is the best choice for modern supermarkets, chain stores, department stores and convenient stores.

Xiaoya Retail has created an advanced management system for R&D and quality control, it is also certified with ISO9001, ISO14001, OHSAS18001, CE, etc. Imported the advanced inspection and test facilities from Italy, Switzerland and Japan, Xiaoya Retail have the international first-class quality inspection line and test room. The company has made its own strict quality evaluation system to make sure its quality control system is scientifically executed according to ISO9001. Xiaoya showcases have passed the strict examination by many retail giants, such as Tesco, Wal-Mart, CN Vanguard, Suning.com etc. and entered into their supermarkets. The products have been sold to many countries and regions, such as US, UK, France, Italy, Russia, Australia, Southeast Asia.

Xiaoya Retail, with the case of product quality to keep itself vigorous, with the updated technology to keep itself competitive, always create the innovative products and supply with good service for the purpose of making up life happier and healthier.





品质铸造辉煌

二十年的行业专注，让我们更专业

精益求精 严谨务实 勇于创新 脚踏实地

E7

壁式冷冻冷藏展示柜

Remote Frozen & Refrigerated Multi-deck Display Case

E7 奥克兰/赫米特
E7 AUCKLAND / E7 HEMET

E7 马里兰/麦克林
E7 MARYLAND / E7 MCLEAN

E8 奥兰多
E8 ORLANDO

E7 亚特兰大/迈阿密
E7 ATLANTA / E7 MIAMI

E7 圣保罗
E7 ST. PAWL

E7 奥斯汀
E7 AUSTIN

E7 尤瑞克
E7 EURAKA





产品用途 PURPOSE

★运行温度为3M1(-1~5℃)时,用于展示和销售海产品、鲜肉类、奶制品等;运行温度为3M2(-1~7℃)时,用于展示和销售饮料、香肠类、熟食品等日配品;运行温度为3H(1~10℃)时,用于展示和销售各种水果、蔬菜等。
★长度有1875mm、2500mm、3750mm三种规格,可以任意拼接。

★The different temperature ranges can be set according to the different demands: 3M1(-1~5℃) for marine products and fresh meat and dairy products; 3M2(-1~7℃) for dairy products, such as beverage, sausages and cooked foods; 3H(1~10℃) for fruits and vegetables, etc.
★3 basic length specifications: 1875mm, 2500mm and 3750mm. Can be jointed together freely.

产品型号 PRODUCT MODEL

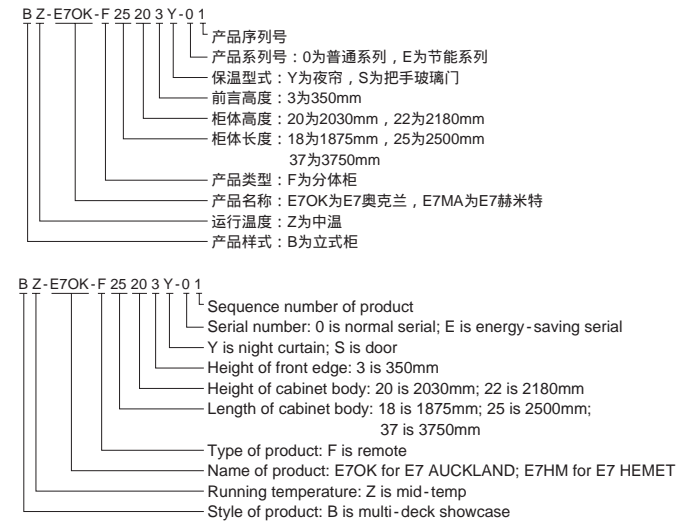

产品特点 CHARACTERISTIC

- ★容积大, 占地面积小。
 - ★前沿高度低, 开口展示面积大, 增加食品的展示效果。
 - ★多层搁板任意组合, 角度可调。
 - ★采用梯形层流风幕和背板出风技术, 温度均匀, 有效降低冷柜能耗。
 - ★采用高效预冷波纹翅片式蒸发器, 提高展示柜的制冷性能。
 - ★设计双灯开关, 顶灯和搁板灯分开控制, 按需节能。
 - ★防凝露开关设计, 适应不同卖场环境工况。
 - ★可选钢化中空玻璃门, 安全、卫生、节能。
 - ★可选顶部镜子结构, 增加展示效果。
- ★Large volume, small occupied area.
 - ★Low height of the front edge and large open display area provide the better display effect.
 - ★Multi-layer shelf board freely combine with angle adjustable,
 - ★The technology of trapezoid laminar flow air curtain and air outlet from back board ensure the air flow evenly and energy-conservation.
 - ★High efficiency pre-cooling corrugated fins of evaporator increases cooling performance.
 - ★Top light and shelf light are controlled separately to save energy.
 - ★Anti-condensation switch design suits for all different ambient condition.
 - ★Optional tempered glass door ensures safe, hygienic and energy-efficient.
 - ★Optional top mirror structure for better display effect.

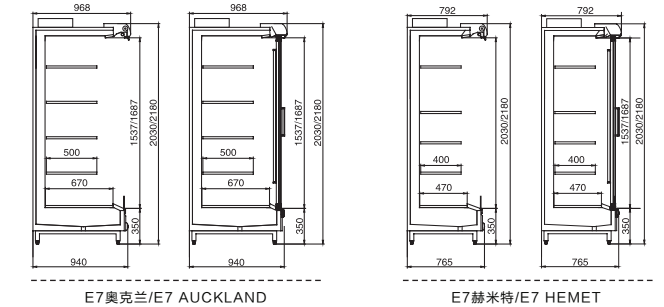

E7 奥克兰/赫米特
E7 AUCKLAND / E7 HEMET

节能低耗 全面升级
制冷快 低耗能 能效比高

QUALITY OPENS AN INNOVATIVE ERA
TECHNOLOGY CONDUCTS THE BRIGHT FUTURE





产品用途 PURPOSE

★3M1(-1~5℃)用于展示和销售海产品、鲜肉类；3M2(-1~7℃)用于展示和销售饮料、奶制品、香肠类、熟食品等日配品；3H(1~10℃)用于展示和销售各种水果、蔬菜等食品。

★长度有1875mm、2200mm、2500mm、3750mm四种规格，可以任意拼接。

★The different temperature ranges can be set according to the different demands:3M1(-1~5℃) for marine products and fresh meat; 3M2(-1~7℃) for dairy products, such as beverage, milk, sausages and cooked foods; 3H(1~10℃) for fruits and vegetables, etc.

★4 basic lengths specifications:1875mm, 2200mm, 2500mm and 3750mm. Can be jointed together freely to suit your length requirements.

产品型号 PRODUCT MODEL

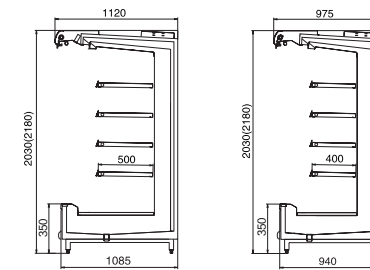

E7马里兰/E7 MARYLAND E7麦克林/E7 MCLEAN

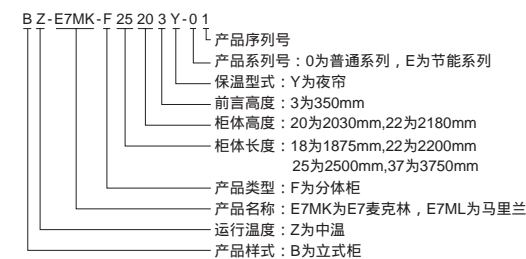

产品特点 CHARACTERISTIC

- ★外观豪华气派，开口展示面积大，能最大限度的增加食品的展示效果。
- ★双层风幕设计使风幕更加均匀，形成风幕的风速和温度梯度，减少冷柜的热负荷，达到节能的目的，比传统陈列柜节能35%以上。
- ★该产品制冷快，温度均匀，提高了食品的保鲜品质。
- ★排水管前置，控制盒盖可掀，方便安装、操作和维修，降低维护和维修成本。
- ★该产品设计有双灯开关，顶灯和搁板灯分开控制，便于控制节能。
- ★可选顶部镜子结构，增加展示效果。

★Luxury out-looking with big display area provides the best display effect.

★Double air curtain can make a even cooling environment and form the wind speed and temperature gradient, reduce the heat load of showcases to achieve the goal of energy conservation, so the efficient showcase consumes 35% less electricity than traditional models.

★Fast cooling and even temperature improve the quality of food preservation.

★Preposed drain-pipes and liftable cover of the controller box ensure easy to install/ operate/ repair and reduce maintenance cost.

★Top light and shelf light are controlled separately to save energy.

★Optional top mirror structure for better display effect.

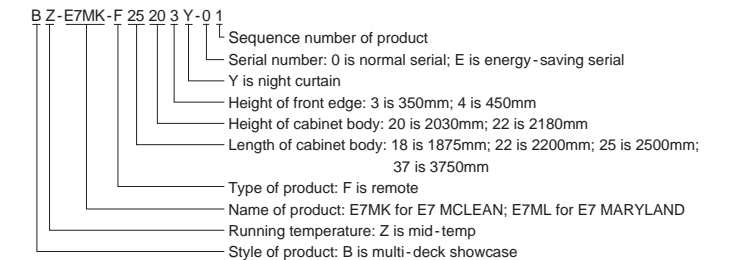

E7 马里兰/麦克林

E7 MARYLAND / E7 MCLEAN

节能降耗 绿色环保

制冷快 均匀制冷 高效节能

QUALITY OPENS AN INNOVATIVE ERA
TECHNOLOGY CONDUCTS THE BRIGHT FUTURE





产品用途 PURPOSE

★运行温度为3M1(-1~5℃)时,用于展示和销售各种海产品、鲜肉类等冷藏食品。运行温度为3M2(-1~7℃)时,用于展示和销售各种饮料、奶制品、香肠类、熟食等日配品。运行温度为3H1(1~10℃)时,用于展示和销售各种水果、蔬菜等食品。

★高度有1300mm、1600mm两种规格,长度有1250mm、1875mm、2500mm、3750mm四种基本规格,可以任意拼接,也可以与环岛柜拼接。

★The different temperature ranges can be set according to the different demands: 3M1(-1~5℃) for marine products and fresh meat; 3M2(-1~7℃) for dairy products, such as beverage, milk, sausages and cooked foods; 3H1(1~10℃) for fruits and vegetables, etc.

★2 specification of height: 1300mm and 1600mm.
4 basic length specifications:1250mm, 1875mm, 2500mm and 3750mm. Can be jointed together freely to suit your length requirements, also can be jointed as a roundabout.

产品型号 PRODUCT MODEL

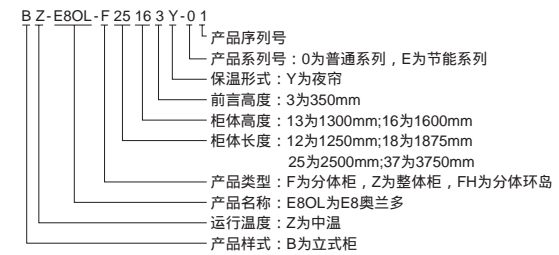
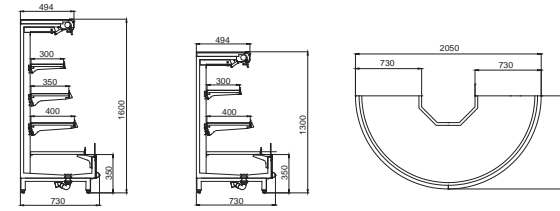

产品特点 CHARACTERISTIC

- ★采用阶梯式搁板,形成瀑布式风幕,柜内温度均衡。
- ★采用优质夜帘保温,美观,性能好。
- ★零部件进行防腐防锈处理,美观大方,适合各大小超市,也可环岛拼接。
- ★蒸发风机采用挂接方式,控制盒可抽拉,方便安装和维修。
- ★采用名牌控制器,可实现多方面控制调节。
- ★采用独特的梯形层流风幕设计和背板出风技术,梯度出风均匀,有效降低陈列柜能耗。
- ★多层搁板任意组合,角度可调,可根据卖场要求调节不同的展示效果。

- ★Trapezoid shelves, waterfall air curtain and uniform temperature.
- ★High-quality cloth fibre curtain make the temperature stable with beautiful appearance and good performance.
- ★Anti-corrosion & anti-rust treatment for spare parts, good appearance, suitable for all kinds of supermarket and convenience store.
- ★Evaporator fan in hanging type and control box can be push-pull are easy to install and repair.
- ★Famous brand controller can realize various control adjustment.
- ★Unique technology of trapezoid laminar flow air curtain and air outlet from back board ensure the air flow evenly and energy-conservation.
- ★Multi-layer shelves can be combined freely with angle adjustable to achieve different display effects.



两种高度 多种选择

温度均匀 外形美观 降低能耗

QUALITY OPENS AN INNOVATIVE ERA
TECHNOLOGY CONDUCTS THE BRIGHT FUTURE





产品用途 PURPOSE

★运行温度为-1~5℃时，用于展示和销售生鲜、肉类、乳制品及饮料等，运行温度为-18~-22℃时，用于展示和销售各种冷冻食品、冰淇淋、海产品等。

★长度有1500mm(两门)、2250mm(三门)、3000mm(四门)、3750mm(五门)四种基本规格，可以任意拼接。

★The different temperature ranges can be set according to the different demands: -1~5℃ for fresh foods, fresh meat, milk, beverage and so on; -18~-22℃ for frozen foods, ice cream, sea foods, etc.

★4 basic length specifications: 1550mm(2 doors), 2250mm(3 doors), 3000mm(4 doors) and 3750mm(5 doors). Can be jointed together freely.

产品型号 PRODUCT MODEL

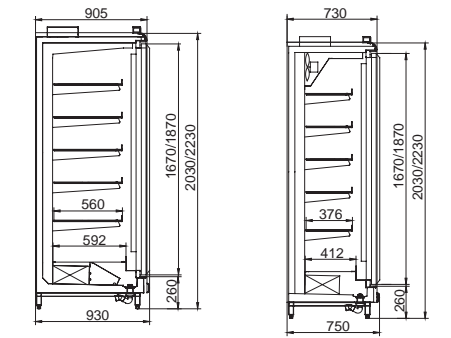

E7亚特兰大/E7 ATALANTA E7迈阿密/E7 MIAMI

产品特点 CHARACTERISTIC

- ★采用冷风分流结构，制冷效果均匀，消除制冷死角。
- ★电加热防凝露玻璃门设计，节能降耗。
- ★玻璃门自动关闭设计，使用方便。
- ★多层网层板自由组合，角度可调，增加展示效果。
- ★充分利用卖场空间，与同容积岛柜相比，占地面积少60%。
- ★运行成本低，同等情况下，比开口柜节能50%，一次投资，终生受益。

- ★The shunt structure of cooling air is adopted to achieve uniform cooling effect and to eliminate the cooling dead ends.
- ★Glass door with electrical heating and anti-condensation reduces power consumption.
- ★Glass door can close automatically.
- ★Multi-layer grid shelves can be combined freely with angle adjustable to augment display effects.
- ★Save 60% space compared to same volume island freezer.
- ★Save 50% energy compared to open type, Low running cost, invest one-off, benefit lifelong.

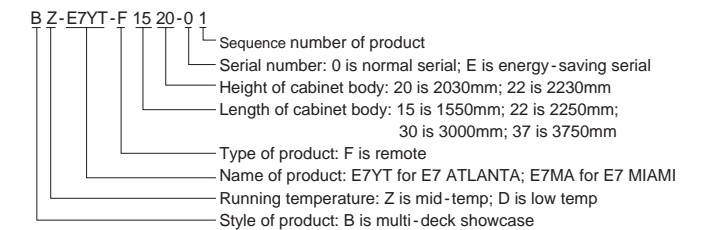

E7 亚特兰大/迈阿密
E7 ATLANTA / E7 MIAMI

均匀制冷 节能低耗
无制冷死角 占地空间小

QUALITY OPENS AN INNOVATIVE ERA
TECHNOLOGY CONDUCTS THE BRIGHT FUTURE





产品用途 PURPOSE

- ★运行温度为 $\leq -18^{\circ}\text{C}$ ，用于展示和销售各种冷冻食品、冰淇淋、海产品等。
- ★长度有1250mm(两门)、1875mm(三门)、2200mm(三门)、2500mm(四门)、3750mm(六门)五种基本规格，可以任意拼接。
- ★ $\leq -18^{\circ}\text{C}$ for frozen foods, ice cream, sea foods, etc.
- ★5 basic length specifications: 1250mm (2 doors), 1875mm (3 doors), 2250mm (3 doors) 2500mm (4 doors) and 3750mm (6 doors). Can be jointed together freely.

产品型号 PRODUCT MODEL

- B D-E7SP-F 25 20 5 Y-0 1
- 产品序列号
 - 产品系列号：0为普通系列，E为节能系列
 - 保温形式：Y为夜帘，T为推拉门
 - 前言高度：5为530mm
 - 柜体高度：20为2030mm, 22为2180mm, 23为2280mm
 - 柜体长度：12为1250mm, 18为1875mm, 22为2200mm, 25为2500mm, 37为3750mm
 - 产品类型：F为分体柜
 - 产品名称：E7SP为E7圣保罗
 - 运行温度：D为低温柜
 - 产品样式：B为立式柜
- B D-E7SP-F 25 20 5 Y-0 1
- Sequence number of product
 - Serial number: 0 is normal serial; E is energy-saving serial
 - Y is night curtain; T is sliding door
 - Height of front edge: 5 is 530mm
 - Height of cabinet body: 20 is 2030mm; 22 is 2180mm; 23 is 2280mm
 - Length of cabinet body: 12 is 1250mm; 18 is 1875mm; 22 is 2200mm; 25 is 2500mm; 37 is 3750mm
 - Type of product: F is remote
 - Name of product: E7SP for E7 ST. PAWL
 - Running temperature: D is low temp
 - Style of product: B is multi-deck showcase

产品特点 CHARACTERISTIC

- ★充分利用卖场空间，比一般冷冻柜占地少50%。运行成本低，比开口岛柜节能50%，一次投资终生受益。
- ★电加热防凝露玻璃门设计，玻璃门自动关闭，自锁结构设计，使用方便。
- ★多层网层板自由组合，可以满足商品不同展示效果。
- ★顶部可选灯座板或装饰板结构，满足不同客户的不同需要。
- ★可选LED灯，节能展示效果好。
- ★可选夜帘或岛式推拉门结构，节能降耗。
- ★Save 50% space compared with normal freezer, make full use of store space. Save 50% energy compared with open type. Low running cost, invest one-off, benefit lifelong.
- ★Electrical heating anti-condensation glass door with auto-closed and auto-locked design is convenient to use.
- ★Multi-layer grid shelves combined freely can satisfy different display effects.
- ★Top with lamp holder or decorative sheet satisfy different customers demands.
- ★With LED light, good energy-saving and display effect.
- ★Night fibre curtain or top sliding door is optional for energy-saving.

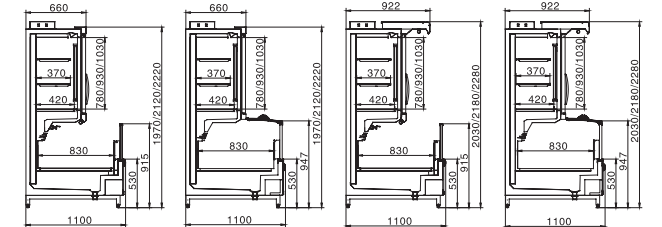

节能低耗 节约空间
容量大 占地少 能效比高

QUALITY OPENS AN INNOVATIVE ERA
TECHNOLOGY CONDUCTS THE BRIGHT FUTURE





双温双控 节能环保

降温快 有效容积大

QUALITY OPENS AN INNOVATIVE ERA
TECHNOLOGY CONDUCTS THE BRIGHT FUTURE

产品用途 PURPOSE

- ★底部冷冻部分运行温度为 $\leq -18^{\circ}\text{C}$ ，用于展示和销售各种肉制品、海产品、冰淇淋、速冻水饺等冷藏食品等。顶部冷藏部分运行温度 $-1\sim 7^{\circ}\text{C}$ ，用于展示和销售各种饮料、奶制品、真空包装熟食等。
- ★柜子为分体柜，柜长有1875mm,2500mm,3750mm三种长度。

- ★ $\leq -18^{\circ}\text{C}$ of bottom cabinet for frozen foods, ice cream, sea foods, etc. $-1\sim 7^{\circ}\text{C}$ of top cabinet for beverage, milk and cooked food.

- ★3 basic length specifications: 1875mm, 2500mm and 3750mm. Can be jointed together freely to suit your length requirements.

产品型号 PRODUCT MODEL

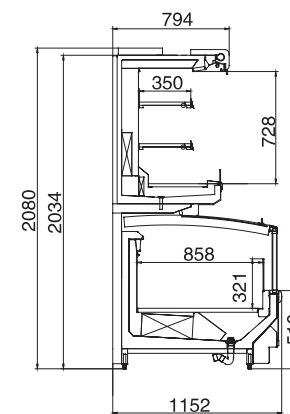

产品特点 PRODUCT FEATURES

- ★冷冻冷藏两种柜型集一身，实现不同使用需求。
- ★冷冻部分加热反射玻璃推拉门，减少冷量消耗，降低能耗。
- ★超薄大面积蒸发器，降温快，有效容积大。
- ★零部件进行静电喷涂防腐防锈处理。
- ★新型绿色环保聚氨酯整体发泡工艺，保温性能好。

- ★Integration cooling and frozen two types of cabinets in one achieve different use requirements. Large Effective volume.

- ★Anti-reflective sliding glass-door for bottom freezer can reduce cooling consumption and save energy.

- ★Ultra-thin and large area high-efficient evaporator rapidly cool fast.

- ★Spare parts with anti-corrosion anti-rust treatment.

- ★New green environment-friendly polyurethane foaming process with good insulation performance.

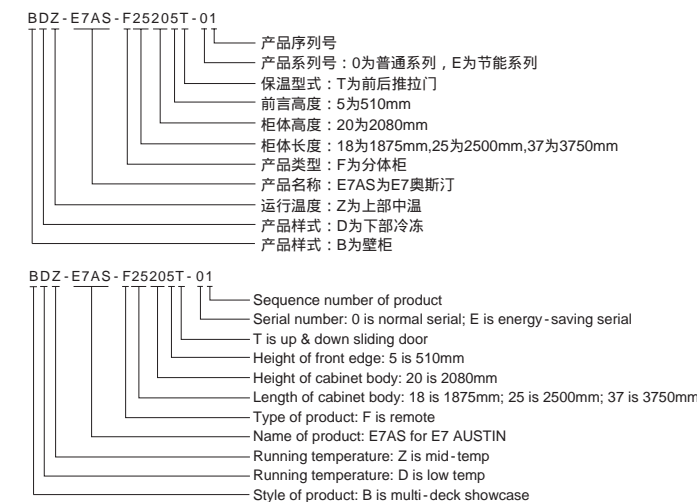



产品用途 PURPOSE

- ★该柜型的温度等级：3H（1~10℃），用于展示和销售各种水果、蔬菜等食品。
- ★该柜型为分体柜，长度有：1250mm，1875mm，2500mm，3750mm四种规格，可以任意拼接。
- ★H(1~10℃) for fruits and vegetables, etc.
- ★4 basic length specifications: 1250mm, 1875mm, 2500mm and 3750mm. Can be jointed together freely to suit your length requirements.

产品型号 PRODUCT MODEL

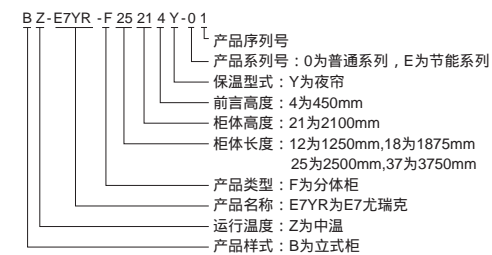
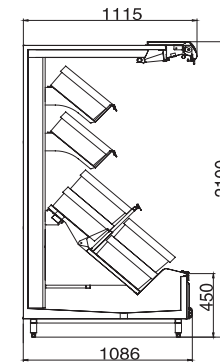

产品特点 CHARACTERISTIC

- ★外观豪华气派，前沿高度低，开口展示面积大，能最大限度的增加食品的展示效果。
- ★容积大，占地面积小。
- ★采用独特的梯形层流风幕设计和背板出风技术，梯度出风均匀，有效降低陈列柜能耗。
- ★该产品制冷快，温度均匀，提高了食品的保鲜品质。
- ★设计有可扣接式蒸发风机座板结构，控制器置顶，方便安装、操作、维修及维护清洗保养。
- ★采用框篮和倾斜隔板结构，适合水果、蔬菜的放置和展示。
- ★顶部采用双排灯设计，增加柜内亮度，展示效果好。

- ★Luxury out-looking low front with big display area provide the best display effect.
- ★Big Volume and small floor space.
- ★Unique technology of trapezoid laminar flow air curtain and air outlet from back board ensure the air flow evenly and energy-conservation.
- ★Fast cooling and even temperature improve the quality of food preservation.
- ★The design of the buckle structure of evaporating fan holder and the controller ceiling-mounted is easy for installation, operation, daily maintenance and after-sales service.
- ★Basket and inclined partition board is suitable for placing and displaying fruit and vegetable.
- ★Double row of top lights augment the brightness and better display effect.

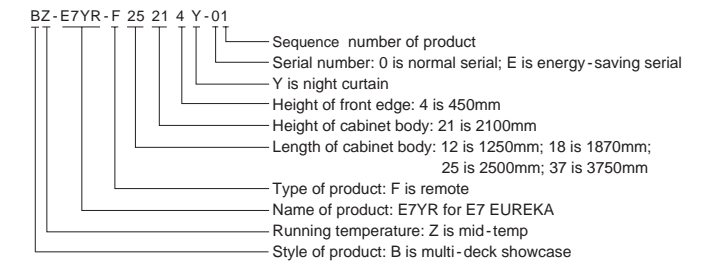

节能低耗 展示面大
制冷快 静音低耗能 能效比高

QUALITY OPENS AN INNOVATIVE ERA
TECHNOLOGY CONDUCTS THE BRIGHT FUTURE





品质铸造辉煌

二十年的行业专注，让我们更专业

精益求精 严谨务实 勇于创新 脚踏实地

E7

岛式冷冻展示柜

Remote Island Self Service
Frozen & Refrigerated Merchandiser

E7夏威夷/华盛顿
E7 HAWAII / E7 WASHINGTON

E7印第安纳
E7 INDIANA

E7加利福尼亚
E7 CALIFORNIA

E8兰辛
E8 LANSING





产品用途 PURPOSE

★运行温度为-18~-22℃时,用于展示和销售各种冷冻食品、冰淇淋、海产品等。
★长度有1875mm、2500mm、3750mm三种基本规格,可以任意拼接,可选配封头柜。

★-18~-22℃ for frozen foods, ice cream, sea foods, etc.
★3 basic length specifications: 1875mm, 2500mm and 3750mm. Can be jointed together freely to suit your length requirements. Terminal cabinet is available.

产品型号 PRODUCT MODEL

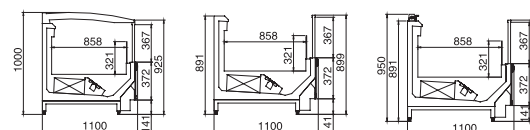

E7夏威夷 华盛顿封头柜
Terminal cabinet of E7 WASHINGTON / E7 HAWAII

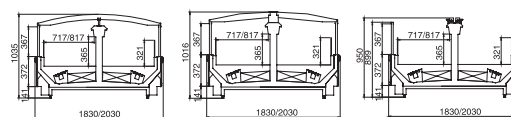

E7夏威夷柜体宽度为1830mm, E7华盛顿柜体宽度为2030mm
Width of cabinet body of E7 HAWAII is 1830mm.
Width of cabinet body of E7 WASHINGTON is 2030mm.

DD-E7XW-F 25 5 Y-0 1

- 产品序列号
- 产品系列号: 0为普通系列, E为节能系列
- 保温形式: Y为夜帘, Q为前后推拉门
- 前沿高度: 5为513mm
- 柜体长度: 18为1875mm, 25为2500mm, 37为3750mm
20为2030mm (E7华盛顿封头柜)
18为1830mm (E7夏威夷封头柜)
- 产品类型: F为分体柜
- 产品名称: E7XW为E7夏威夷, E7HS为E7华盛顿
E7XF为E7夏威夷封头柜, E7HF为E7华盛顿封头柜
- 运行温度: D为低温
- 产品样式: D为岛柜

产品特点 PRODUCT FEATURES

★采用非对称层流风幕结构, 制冷效果均匀, 彻底解决了霜堵问题。
★采用高效蒸发器和进口热力膨胀阀, 减少除霜时间, 降低能耗。
★零部件进行防腐防锈处理, 铝合金采用磨砂氧化处理, 外观件采用静电喷涂处理。
★可选配夜帘、夜盖或玻璃推拉门, 节能降耗, 保证展示食品卫生。
★可选配非冷货架, 实现商品关联陈列, 优化卖场环境, 促进展品销售。
★可配备电脑远程监控系统, 对产品运行情况进行实时监控。

★Asymmetric laminar flow air curtain effects the cooling evenly and thoroughly solve the problem of frost-blocking.
★High efficiency evaporator and imported expansion valve are used to cut down the defrost time and save energy.
★Spare parts for anti-corrosion anti-rust treatment, aluminum alloy with matte oxidation treatment, exterior appearance parts in electrostatic spraying treatment.
★Night fibre curtain, night cover or top sliding door are optional to help in energy-saving and cost-reducing and general hygiene of commodity.
★Optional non-cooling storage rack can be mounted on top of the freezer for correlated non-refrigerated product selling.
★Optional computer remote monitoring system can monitor the running of all commodities.

DD-E7XW-F 25 5 Y-0 1

- Sequence number of product
- Serial number: 0 is normal serial; E is energy-saving serial
- Y is night curtain; Q is up & down sliding door;
- Height of front edge: 5 is 513mm
- Length of cabinet body: 18 is 1875mm; 25 is 2500mm; 37 is 3750mm
20 is 2024mm (terminal cabinet of E7 WASHINGTON)
18 is 1824mm (terminal cabinet of E7 HAWAII)
- Type of product: F is remote
- Name of product: E7XW for E7 HAWAII; E7HS for E7 WASHINGTON;
E7HF for terminal cabinet of E7 WASHINGTON;
E7XF for terminal cabinet of E7 HAWAII
- Running temperature: D is low temp
- Style of product: D is island showcase

E7 夏威夷/华盛顿
E7 HAWAII / E7 WASHINGTON

多核心制冷技术
低能耗 高能效

QUALITY OPENS AN INNOVATIVE ERA
TECHNOLOGY CONDUCTS THE BRIGHT FUTURE





产品用途 PURPOSE

- ★运行温度为-18~-22℃时,用于展示和销售各种冷冻食品、冰淇淋、海产品等。
- ★长度有1875mm、2500mm、3750mm三种基本规格,可以任意拼接,可选配封头柜。
- ★-18~-22℃ for frozen foods, ice cream, sea foods, etc.
- ★3 basic length specifications:1875mm, 2500mm and 3750mm. Can be jointed together freely to suit your length requirements. Terminal cabinet is available.

产品型号 PRODUCT MODEL

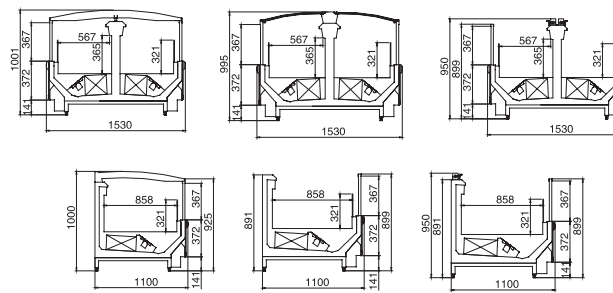

E7印第安纳封头柜/Terminal cabinet of E7 INDIANA

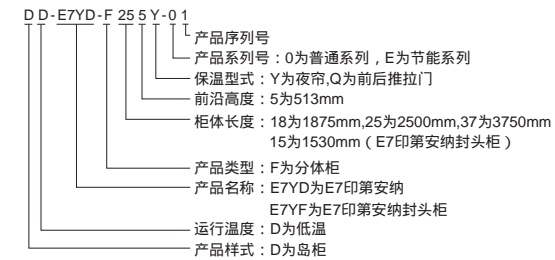

产品特点 PRODUCT FEATURES

- ★采用非对称层流风幕结构, 制冷效果均匀, 彻底解决了霜堵问题。
- ★采用高效蒸发器和进口热力膨胀阀, 减少除霜时间, 降低能耗。
- ★零部件进行防腐防锈处理, 铝合金采用磨砂氧化处理, 外观件采用静电喷涂处理。
- ★可选配夜帘、夜盖或玻璃推拉门, 节能降耗, 保证展示食品卫生。
- ★可选配非冷货架, 实现商品关联陈列, 优化卖场环境, 促进展品销售。
- ★可配备电脑远程监控系统, 对产品运行情况进行实时监控。
- ★Asymmetric laminar flow air curtain effects the cooling evenly and thoroughly solve the problem of frost-blocking.
- ★High efficiency evaporator and imported expansion valve are used to cut down the defrost time and save energy.
- ★Spare parts for anti-corrosion anti-rust treatment, aluminum alloy with matte oxidation treatment, exterior appearance parts in electrostatic spraying treatment.
- ★Night fibre curtain, night cover or top sliding door are optional to help in energy-saving and cost-reducing and general hygiene of commodity.
- ★Optional non-cooling storage rack can be mounted on top of the freezer for correlated non-refrigerated product selling.
- ★Optional computer remote monitoring system can monitor the running of all commodities.

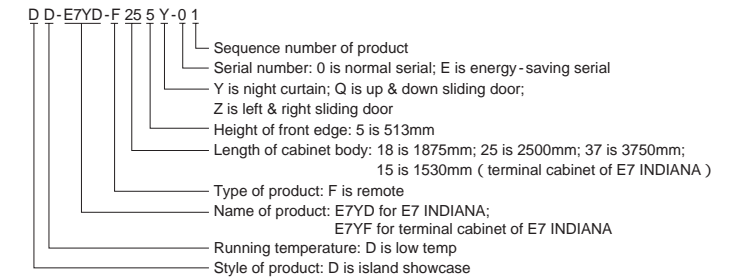

非对称层流风幕技术

制冷更均匀 风冷无霜

QUALITY OPENS AN INNOVATIVE ERA
TECHNOLOGY CONDUCTS THE BRIGHT FUTURE





产品用途 PURPOSE

★运行温度为-18~-22℃时，用于展示和销售各种冷冻食品、冰淇淋、海产品等。
★长度有1875mm、2500mm、3750mm三种基本规格，可以任意拼接。背靠背使用时，配有封头柜。

★-18~-22℃ for frozen foods, ice cream, sea foods, etc.
★3 basic length specifications: 1875mm, 2500mm and 3750mm. Can be jointed together to suit your length requirements. Terminal cabinet is available.

产品特点 PRODUCT FEATURES

★采用非对称层流风幕结构，制冷效果均匀，降低耗电量。
★采用高效蒸发器和进口热力膨胀阀，减少除霜时间，降低能耗。
★零部件全部进行防腐防锈处理，铝合金采用磨砂氧化处理，外观件采用静电喷涂处理。
★配置夜盖、夜帘或推拉门结构，节能降耗，保证展示食品卫生。
★可配备电脑远程监控系统，对产品运行情况进行实时监控。

★Asymmetric laminar flow air curtain effects the cooling evenly and reduce cooling amount.

★High efficiency evaporator and imported expansion valve are used to cut down the defrost time and save energy.

★Spare parts for anti-corrosion anti-rust treatment, aluminum alloy with matte oxidation treatment, exterior appearance parts in electrostatic spraying treatment.

★Night fibre curtain, night cover or top sliding door are optional to help in energy-saving and cost-reducing and general hygiene of commodity.

★Optional computer remote monitoring system can monitor the running of all commodities.

产品型号 PRODUCT MODEL

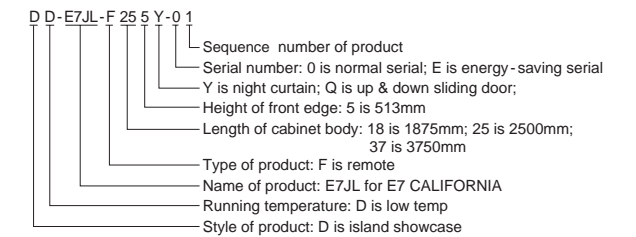
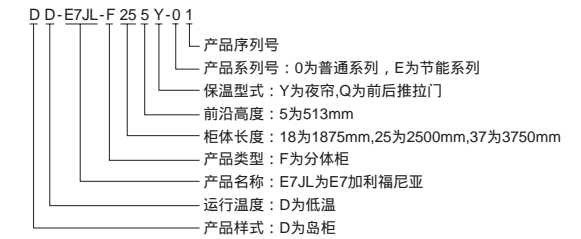
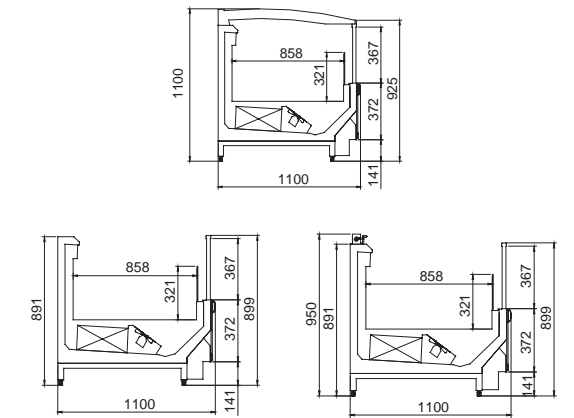

靠墙放置 节省空间

制冷更均匀 无霜技术

QUALITY OPENS AN INNOVATIVE ERA
TECHNOLOGY CONDUCTS THE BRIGHT FUTURE





品质铸造辉煌

二十年的行业专注，让我们更专业

精益求精 严谨务实 勇于创新 脚踏实地

E7

柜台式展示柜

Remote & Self-contained
Counter Type Merchandiser

E6阿拉斯加(冷柜)
E6 ALASKA(Refrigerator)

E7维多利亚
E7 VICTORIA

E7匹兹堡
E7 PITTSBURG

E7加利鲜肉柜
E7 CARY

E6阿拉斯加(干热柜)/E6波士顿(湿热柜)
E6 ALASKA(Dry heat)/E6 BosTon(Moist heat)





产品用途 PURPOSE

- ★运行温度为3M1(-1~5℃), 用于展示和销售各种肉类、熟食、乳品及冷饮等食品。
- ★有整体式和分体式两种型式, 长度有1250mm、1875mm、2500mm和3750mm四种基本规格, 可以任意拼接, 可选配90° 拐角柜。
- ★3M1(-1~5℃) for all kinds of meat, cooked foods, milk, cold drink, etc.
- ★2 types: Remote and Self-contained, in 4basic length specifications:1250mm, 1875mm, 2500mm and 3750mm. Can be jointed freely, optionally choose 90 degree angle corner cabinet.

产品型号 PRODUCT MODEL

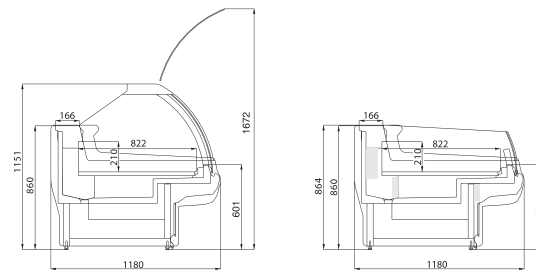

F Z-E6AL-Z 18 K-0 1

- 产品序列号
- 产品系列号: 0为普通系列, E为节能系列
- 保温型式: K为圆形可掀盖型, T为前推拉门, P为平口型
- 柜体长度: 12为1250mm, 18为1875mm, 25为2500mm, 37为3750mm
- 产品类型: Z为整体柜, F为分体柜
- 产品名称: E6AL为E6阿拉斯加
- 运行温度: Z为中温
- 产品样式: F为服务柜

产品特点 PRODUCT FEATURES

- ★有圆弧型可掀盖式、平口型和前推拉玻璃三种外观型式, 满足不同使用需求。
- ★三层均匀风设计, 风幕更优化, 制冷效果更佳, 彻底解决霜堵问题。
- ★大圆弧钢化玻璃, 抗冲击力强, 展示效果佳。
- ★独有台阶式推拉门、电子秤专用插座等, 以人为本设计, 方便使用。
- ★分体柜可配备电脑远程监控系统, 对产品运行情况进行实时监控。
- ★Available in 3 types: round arc liftable glass, flat without cover, front slide glass door, can satisfy different use requirement.
- ★3-layer uniform air flow design, air curtain more optimum, cooling effect more perfect, thoroughly solve the frost-blocking problem.
- ★Large arc tempered glass is used, strong anti-impact and better display.
- ★The unique stepped sliding door and socket of electronic scale, Human Oriented Design, convenient to use.
- ★Optional computer remote monitoring system can real-time monitor the running of the freezers.

F Z-E6AL-Z 18 K-0 1

- Sequence number of product
- Serial number: 0 is normal serial; E is energy-saving serial
- K for curve glass; P for open type
- Length of cabinet body: 12 is 1250mm; 18 is 1875mm; 25 is 2500mm; 37 is 3750mm
- Type of product: Z is plug-in; F is remote
- Name of product: E6AL for E6 ALASKA
- Running temperature: Z is mid-temp
- Style of product: F for counter type showcase

E6 阿拉斯加(冷柜)
E6 ALASKA(Refrigerator)

多种型式 使用广泛
均匀制冷 节能低耗

QUALITY OPENS AN INNOVATIVE ERA
TECHNOLOGY CONDUCTS THE BRIGHT FUTURE



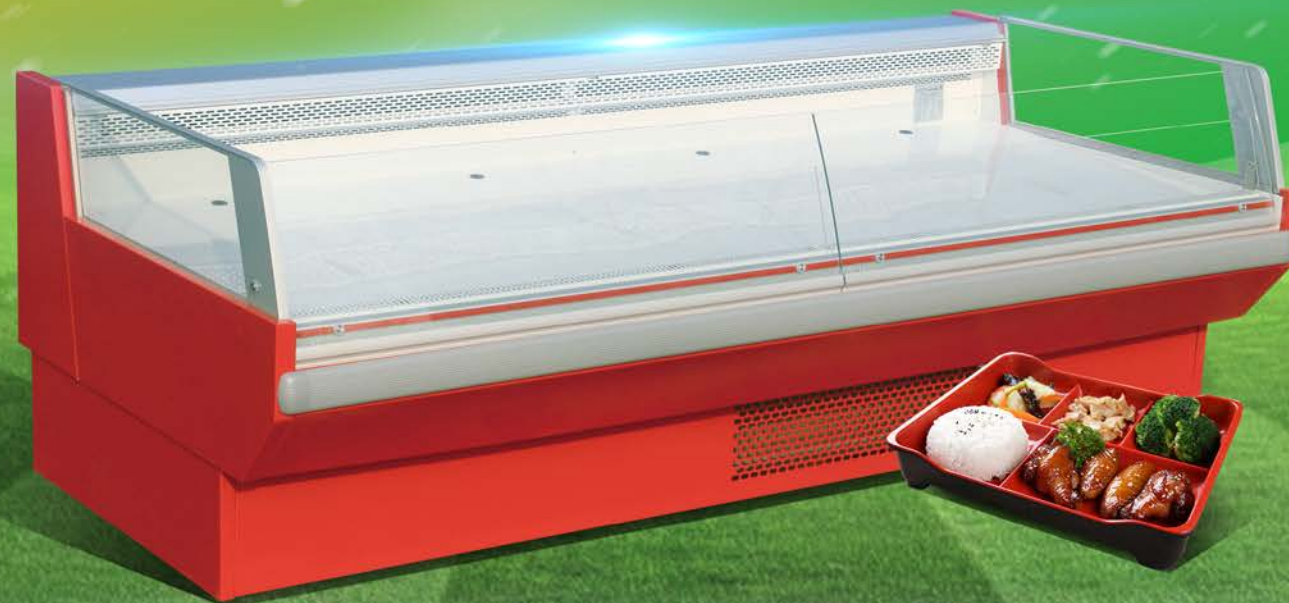
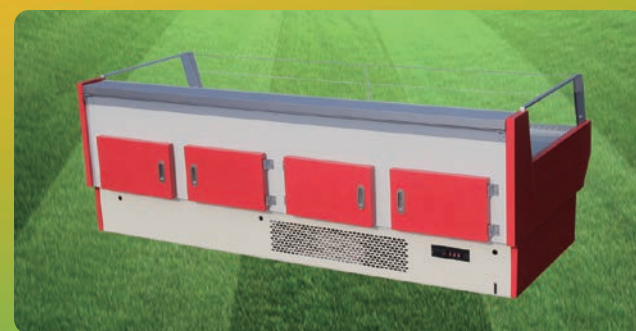

产品用途 PURPOSE

- ★运行温度为3M1 (-1~5℃) 时, 用于展示和销售各种熟食、鲜肉、真空包装食品等冷藏食品。
- ★长度有1875mm、2500mm、3750mm三种基本规格, 可以任意拼接, 也可单独使用。
- ★3M1 (-1℃~5℃) for all kinds of cooked-food, fresh meat, Vacuum-packed food etc.
- ★3 basic length specifications: 1875mm, 2500mm and 3750mm, can be jointed freely, also can be use separately.

产品型号 PRODUCT MODEL

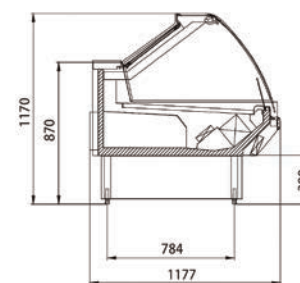

- F Z-E7WD-Z 25 K-0 1
- 产品序列号
 - 产品系列号: 0为普通系列, E为节能系列
 - 保温型式: K为可掀玻璃, P为平口型
 - 柜体长度: 18为1875mm, 25为2500mm, 37为3750mm
 - 产品类型: F为分体柜, Z为整体柜
 - 产品名称: E7WD为E7维多利亚
 - 运行温度: Z为中温
 - 产品样式: F为服务柜

产品特点 PRODUCT FEATURES

- ★采用全景展示的圆弧玻璃结构, 使您所展示的食品一目了然, 展示效果好。
- ★顶部配有明亮柔和的灯光, 使食品的展示效果达到最佳。
- ★采用微电脑控制器, 可实现多方面控制调节。
- ★前部圆弧玻璃可掀开, 后部带有可推拉玻璃, 最大程度方便用户上货、取货; 控制盒可抽拉, 方便安装和维修。
- ★后部超大冷藏储藏室, 增加储物空间, 方便商品储存和补货。
- ★顶部照明, 储藏室照明, 制冷系统, 防凝露系统等分开控制, 方便您的日常使用。
- ★Using panoramic display of arc glass structure, make food inside be clear at a glance and better display effect.
- ★Top with bright and soft light, make food visual effects better.
- ★Adopting microcomputer controller can achieve a wide range of control and regulation.
- ★Front arc glass can be lifted up, rear glass can be slid, which is most convenient for user to load and take out commodities; the controller box can be pulled, easy to install and repair.
- ★Rear with oversize storage room in same temperature as cabinet inside, enlarging storage space and convenient to supplement commodities.
- ★Top lighting, storage room lighting, refrigeration systems and anti-condensation system are controlled separately, convenient to daily use.

- F Z-E7WD-Z 25 K-0 1
- Sequence number of product
 - Serial number: 0 is normal serial; E is energy-saving serial
 - K for curve glass; P for open type
 - Length of cabinet body: 18 is 1875mm; 25 is 2500mm; 37 is 3750mm
 - Type of product: Z is plug-in; F is remote
 - Name of product: E7WD for E7 VICTORIA
 - Running temperature: Z is mid-temp
 - Style of product: F for counter type showcase



超大储藏室 使用方便

大容量 展示效果好

QUALITY OPENS AN INNOVATIVE ERA
TECHNOLOGY CONDUCTS THE BRIGHT FUTURE



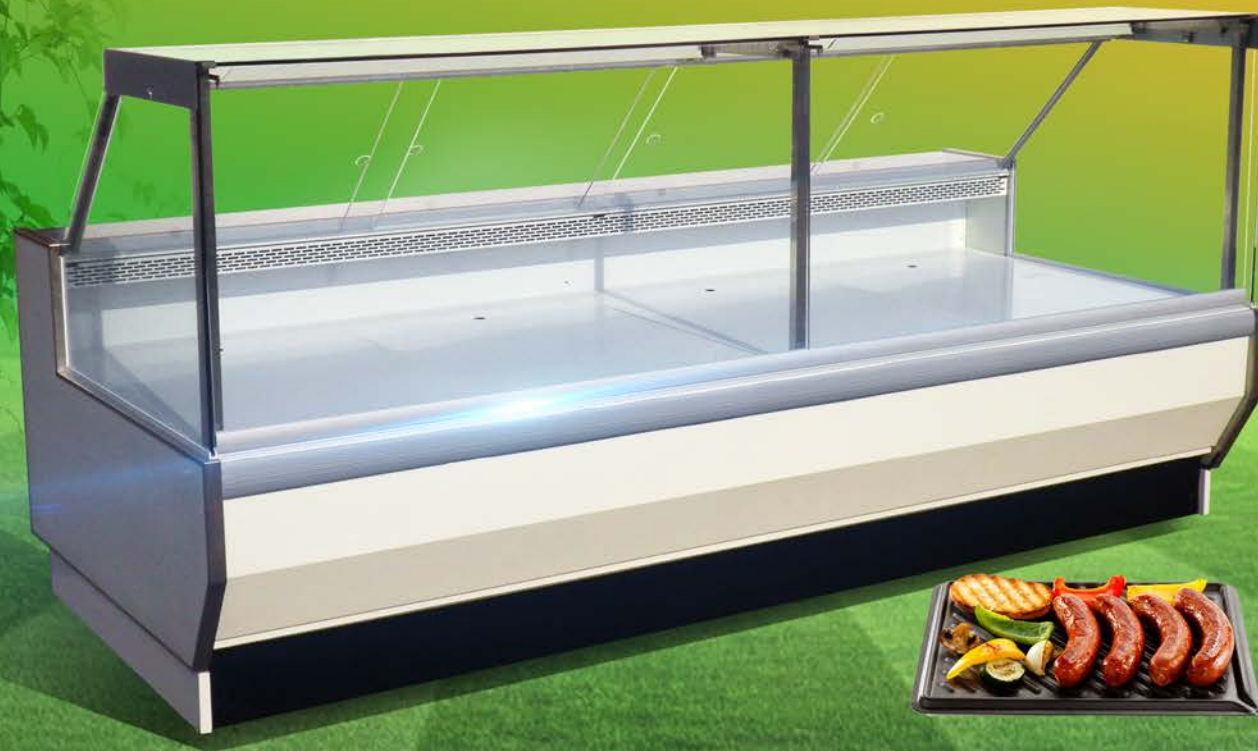

产品用途 PURPOSE

★冷柜运行温度3M1(-1~5℃)时,用于展示和销售各种肉类、水果、熟食、乳品及冷饮等。热柜运行温度60~65℃时,干热柜用于展示和销售各种烤、熏、煎、炸等熟食;湿热柜用于展示和销售成品热菜、蒸煮食品、肉制品等。

★长度有1250mm、1875mm、2500mm、3750mm四种基本规格,可任意拼接。

★M1(-1~5℃) for kinds of meat, fruit, cooked-food, dairy product and cold beverage etc.60~65℃, dry heat cabinet is for baked, smoked, pan fried and deep fried food etc.; moist heat cabinet is for hot-dishes, steamed-boiled food and cooked meat etc.

★4 basic length specifications:1250mm, 1875mm, 2500mm and 3750mm. Can be jointed together freely.

产品特点 PRODUCT FEATURES

- ★有直玻璃和平口型两种外观,可以满足不同使用需求。
- ★冷柜采用双层均风设计,风幕更优化,制冷效果佳。
- ★前面与顶部采用钢化玻璃,抗冲击力强。
- ★超大容积、超大展示面积,展示效果好。
- ★后面配有台阶式推拉门,节能卫生。

★Vertical glass type and flat top-open type can meet different use requirement.

★Double-layer uniform air flow design makes air curtain more optimum and better cooling effect.

★Tempered glass used in front and top guarantee strong anti-impact performance.

★Extra large capacity with extra large display area provides best display effect.

★Sliding door design in rear ensures energy-saving and hygienic.

产品型号 PRODUCT MODEL

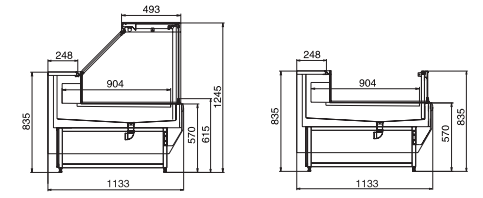

E7匹兹堡 / E7 PITTSBURG

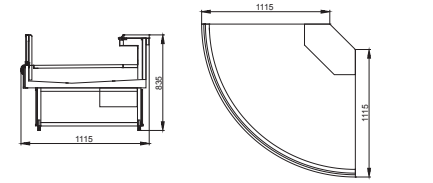

E8匹兹堡 / E8 PITTSBURG

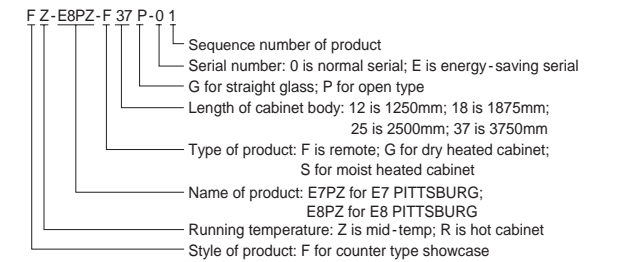
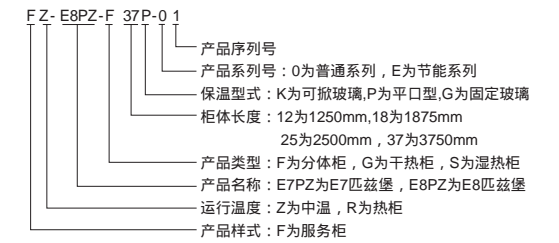

超大展示 全面升级

容量大 温度均匀

QUALITY OPENS AN INNOVATIVE ERA
TECHNOLOGY CONDUCTS THE BRIGHT FUTURE





产品用途 PURPOSE

- ★温度范围：S ($\leq 5^{\circ}\text{C}$) 用于展示和销售海产品、鲜肉类、熟食等；
- ★该柜型为整体柜，长度有：1875mm, 2500mm两种规格，可以任意拼接。
- ★It is used to display and sell seafood, fresh meat and cooked-food etc. at the running temperature of S ($\leq 5^{\circ}\text{C}$).
- ★Both plug-in and remote type, two length specification 1875mm and 2500mm can be jointed randomly.

产品型号 PRODUCT MODEL

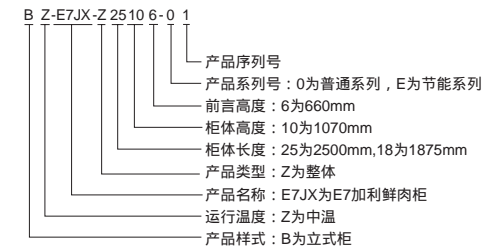
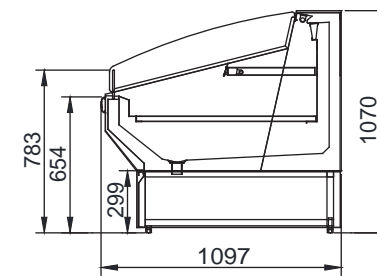

产品特点 PRODUCT FEATURES

- ★外观豪华气派，前沿高度低，开口展示面积大，能最大限度的增加食品的展示效果。
- ★容积大，占地面积小。
- ★采用独特的梯形层流风幕设计和背板出风技术，梯度出风均匀，有效降低陈列柜能耗。
- ★采用名牌压缩机，制冷快，温度均匀，提高了食品的保鲜品质。
- ★蒸发风机采用挂接方式，控制盒和机组可抽拉，方便安装和维修。
- ★采用搁板配置，角度可调，可根据卖场要求调节不同的展示效果。
- ★零部件进行防腐防锈处理，铝合金采用磨砂氧化处理，外观件采用静电喷涂处理。
- ★Luxury appearance, low height of the front edge, large open display area, maximally enlarge display effect.
- ★Large volume, small occupied area.
- ★Unique technology of trapezoid laminar flow air curtain and air outlet from back board ensure the air flow evenly and energy-conservation.
- ★Adopting famous brand compressor, quick cooling, temperature uniformity, improve the quality of fresh food.
- ★Evaporator fan in hanging type and control box can be push-pull, which is easy to install and repair.
- ★Using shelf configuration with adjustable angle, regulate display effect according to store requirements.
- ★Spare parts for anti-corrosion anti-rust treatment, aluminum alloy with matte oxidation treatment, exterior appearance parts in electrostatic spraying treatment.

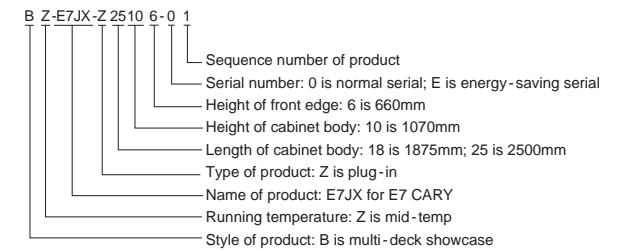

双层设计 节能环保
容积大 制冷快 占地少

QUALITY OPENS AN INNOVATIVE ERA
TECHNOLOGY CONDUCTS THE BRIGHT FUTURE





产品用途 PURPOSE

- ★运行温度为60~65℃，干热柜主要用于保温展示和销售各种烤、熏、煎、炸等熟食；湿热柜主要用于保温展示和销售成品热菜、蒸煮食品、熟肉制品等。
- ★长度有1250mm、1875mm、2500mm、3750mm四种基本规格，可任意拼接。
- ★Running temperature at 60~65℃. Dry heat cabinets for baked, smoked, pan fried and deep fried food, etc. Moist heat cabinet is for hot dishes, steamed-boiled food, cooked meat etc.
- ★4 basic length specifications: 1250mm, 1875mm, 2500mm and 3750mm. Can be jointed together freely.

产品特点 PRODUCT FEATURES

- ★干热柜采用已获国家专利加热技术——热风循环加热方式，温度均匀恒定，食品不易变色，口感好；不会出现传统热柜局部温度过高的现象，且食品干耗比传统热柜低30%。
- ★干热柜加热和照明分开控制，操作方便，节能省电。
- ★湿热柜采用水加热保温方式，柜温更均匀，全自动进水装置，使用更方便。
- ★大圆弧钢化玻璃，抗冲击力强，展示效果佳。
- ★独有台阶式推拉门、电子秤专用插座等，以人为本设计，方便使用。
- ★Adopting national patent heating technology hot: air circulation heating mode in dry heat cabinet effects the inner temperature uniform and constant, the food keep fresh, taste well and do not discolor. It will not appear the inner temperature is much higher in some area like the traditional hot cabinet, and the consumption lower 30% than traditional hot cabinets.
- ★Heating and lighting of dry heat cabinet is controlled separately, easy to be operated and save energy.
- ★With automatic water inlet device, water heating and heat preservation mode used for moist heat cabinet keep the inner temperature more uniform and in convenient use.
- ★Large arc tempered glass is used, strong anti-impact and better display.
- ★The unique stepped sliding door and socket of electronic scale, Human Oriented Design, convenient to use.

产品型号 PRODUCT MODEL

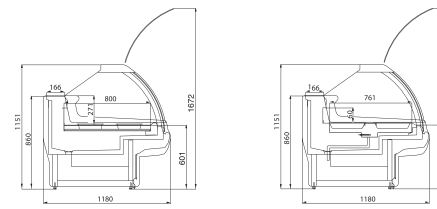

E6阿拉斯加干热柜
E6 ALASKA(Dry heat)

E6波士顿湿热柜
E6 BOSTON(Moist heat)

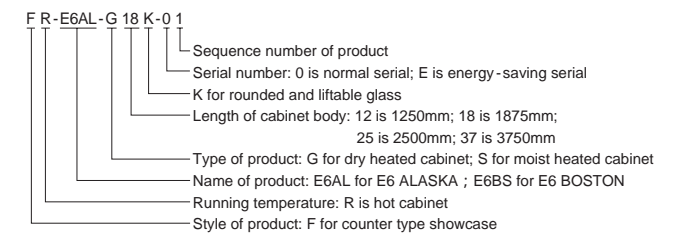
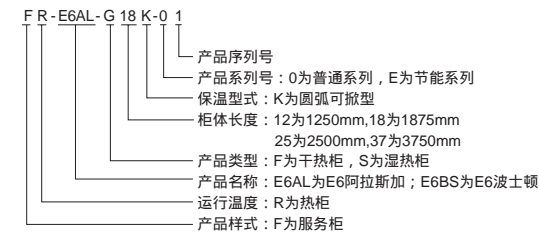

E6 阿拉斯加(干热柜)波士顿(湿热柜)
E6 ALASKA(Dry heat) / E6 BOSTON(Moist heat)

多形式 节能降耗
温度均匀 更安全 更节能

QUALITY OPENS AN INNOVATIVE ERA
TECHNOLOGY CONDUCTS THE BRIGHT FUTURE

