

**Electrical Characteristics:**  
 Current rating: 0.4A AC/DC  
 Voltage rating: 50V AC/DC  
 Temperature range: -25°C~+85°C  
 Withstand Voltage: 200V AC/Minute  
 Contact Resistance:  $\leq 20m\Omega$   
 Insulation resistance:  $\geq 500m\Omega$   
 Relative Humidity: 93%+40°C

**Material Description:**  
 Terminal: Phosphor Bronze Tin-Leocplated  
 Fitting Nail: Brass Tin-plated  
 Housing: Thermoplastic(UL94V-0)  
 Slider: Thermoplastic(UL94V-0)

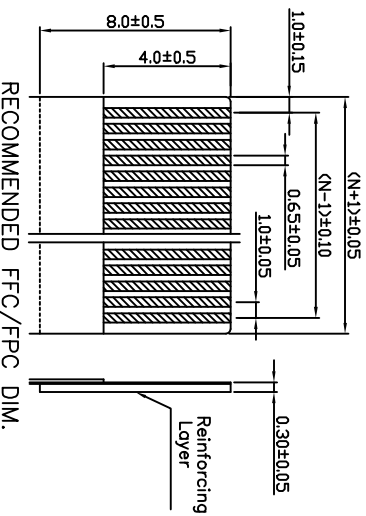

Pin#	DIM=A	DIM=B	DIM=C	DIM=D	DIM=E
30P	36.1	34.8	29.00	31.10	
29P	35.1	33.8	28.00	30.10	
28P	34.1	32.8	27.00	29.10	
27P	33.1	31.8	26.00	28.10	
26P	32.1	30.8	25.00	27.10	
25P	31.1	29.8	24.00	26.10	
24P	30.1	28.8	23.00	25.10	
23P	29.1	27.8	22.00	24.10	
22P	28.1	26.8	21.00	23.10	
21P	27.1	25.8	20.00	22.10	
20P	26.1	24.8	19.00	21.10	
19P	25.1	23.8	18.00	20.10	
18P	24.1	22.8	17.00	19.10	
17P	23.1	21.8	16.00	18.10	
16P	22.1	20.8	15.00	17.10	
15P	21.1	19.8	14.00	16.10	
14P	20.1	18.8	13.00	15.10	
13P	19.1	17.8	12.00	14.10	
12P	18.1	16.8	11.00	13.10	
11P	17.1	15.8	10.00	12.10	
10P	16.1	14.8	9.00	11.10	5.2
9P	15.1	13.8	8.00	10.10	
8P	14.1	12.8	7.00	9.10	
7P	13.1	11.8	6.00	8.10	
6P	12.1	10.8	5.00	7.10	
5P	11.1	9.8	4.00	6.10	
4P	10.1	8.8	3.00	5.10	

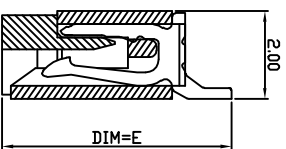
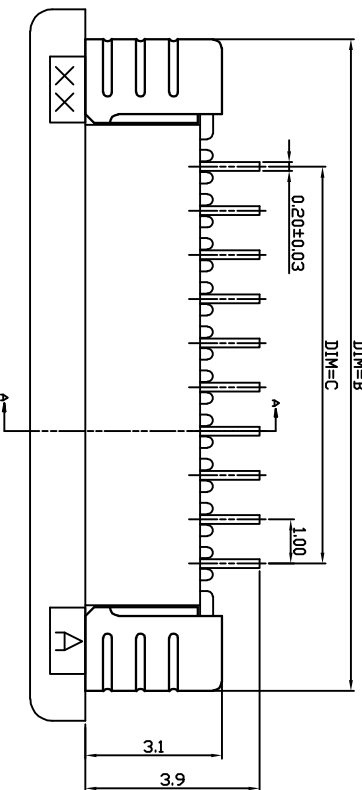
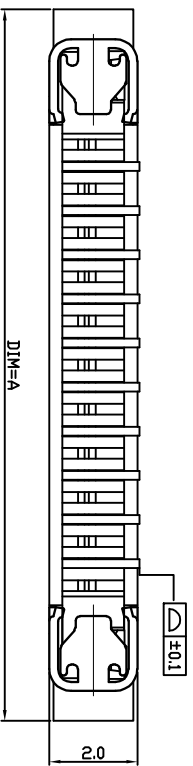
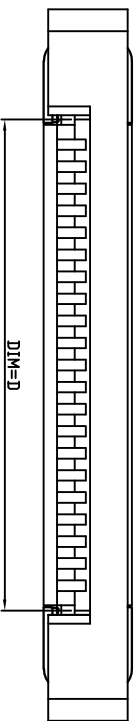

**NOTES:**  
 1. PLASTIC BURRS 0.1mm MAX  
 2. PART NO. SPECIFICATION: 11-36-XX01-12  
 36BOTTOM CONTACT  
 NO. OF CONTACT CODE  
 PLATING

SER AREA	REVISIONS	CHK	DATE	UNIT	MM

**UNLESS OTHERWISE SPECIFIED TOLERANCES ARE:**  
 X.X ±0.15  
 X.XX ±0.05  
 X.XXX ±0.30°

APPROVED	CHECKED	DATE	DRAWING NO.

**DRAWN** 杨大宽  
**DATE** 2008/09/25  
**SCALE** A3  
**COMPUTER NO.** RD0800301  
**NAME** FFC 10 CONNECTOR  
**ZIF FOR SMT(BOTTOM CNM)**  
**REV** A

**APPROVED** 11-36-XX01-12  
**DATE**    
**PART NO.**    
**DRAWING NO.** JB96\*08003  
**COMPUTER NO.** RD0800301  
**NAME** FFC 10 CONNECTOR  
**ZIF FOR SMT(BOTTOM CNM)**  
**REV** A

**东莞市宽拓电子科技有限公司**  
**Dongguan Kuantuo Electronics Co., Ltd**