



FILM SCANNER DV-180N



USER'S MANUAL

CONTENTS

Preface	2
Attention and maintenance	2
Product Structure Diagram.....	3
Reel Attachment Methods.....	5
Film Install Methods.....	7
Power on/off.....	9
Function Setting Menu.....	11
Save the video to PC.....	12
Fast Forward.....	13
Product Specification.....	14
Accessories.....	15
Cleaning.....	16
Declaration.....	16

1. Preface

Thank you for purchasing this product!
Please read this user's guide carefully before you start use this machine.
Please save the manual for your future reference.

2. Attention and maintenance

- Please do not attempt to disassemble or modify any part of the scanner.
- Please do not contact with the inner part of the scanner after dropping the unit or if the unit suffers any other damage.
- Please stop using the product if there is any problem with it, such as smoke or smell while using.
- Please inset the SD card(Over Class6) before starting.
- Please do not use in a dusty or damp environment.
- Please do not overload the USB connections on your computer to avoid overworking the scanner.
- Please use the films of the standard size.
- Cleaning : Make sure the scanner is clean before using to produce a clean image.
- Non use period: The USB cord or adapter should be unplugged from the computer or plug seat when the unit is left unused for a long period of time.
- This item has big noise when working, please don't disturb others.

3.Product Structure Diagram

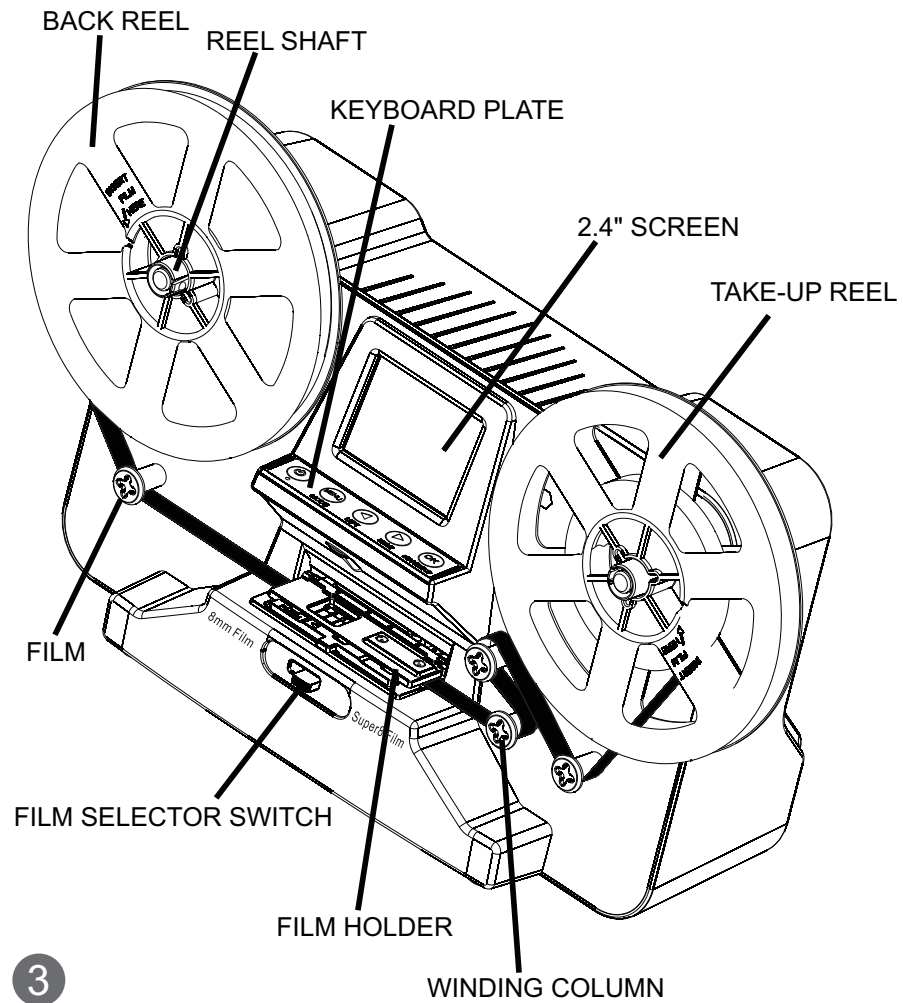

3

12. Cleaning



13.Declaration

Please note products spec is subject to improvement. Any changes of product will not make additional specify.

16

11. Accessories

User's Manual *1
 TV Cable *1
 USB cable *1
 Power adapter *1
 Cleaning Cloth*1
 Reel*1
 Reel shaft plate *2

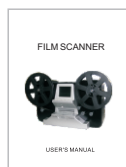

User's Manual



TV cable



USB Cable



DC 12V



Cleaning cloth

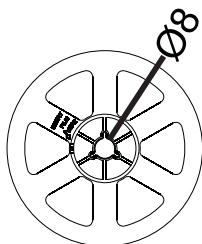

Reel

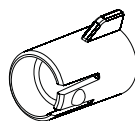

Reel shaft plate

Keyboard

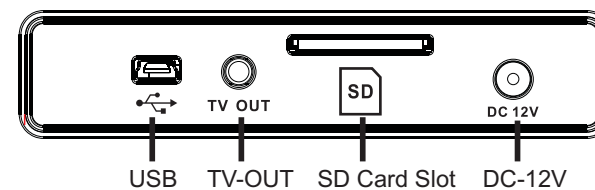
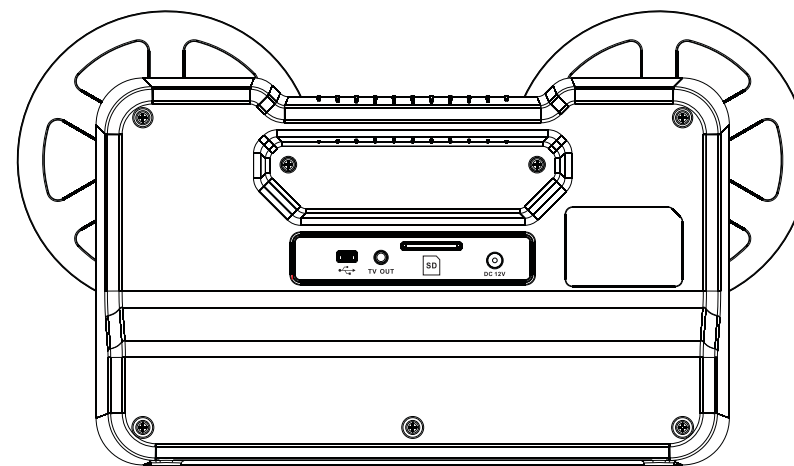
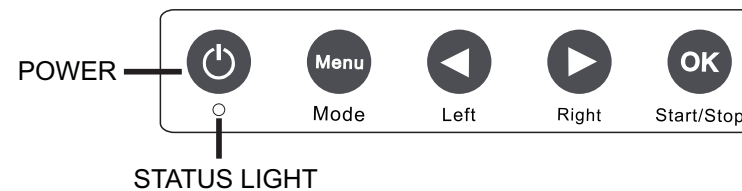

4.Reel Folding Methods

4.1 Reel hole diameter 8mm

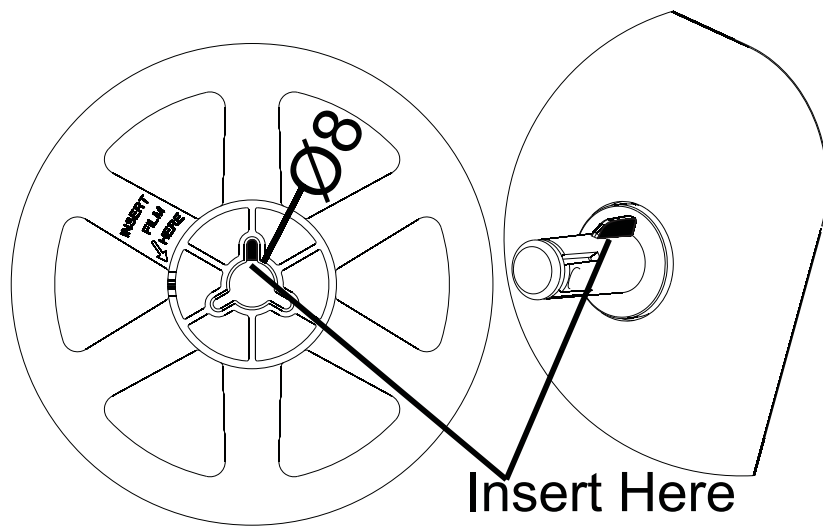

10.Product Specification

Function	Film to Digital Converter
Interface	USB2.0
Image Sensor	3.53Mega pixels (2304 H)x 1536 V) 1 / 3 " CMOS sensor
Display	Color 2.4" TFT LCD
Exposure Control	Automatic / Manual (-2.0 EV~ +2.0EV)
White Balance	Automatic
Resolution	1080P/440/1080/30fps
Frame Rate	20FPS
Scan Method	Video
Film type	5" & 3" Reel 8mm Roll film & Super 8 Roll film
Picture Effects	Positive
File Format	MPEG-4 (MP4)
TV-OUT type	NTSC/PAL
Built-in memory	None
External memory card	SD card up to 32GB
Power Supply	DC 12V
Language	English / French / German / Italian / Spanish / Japanese / S-Chinese / T-Chinese
Support system	Windows XP/vista/Windows 7/8/10/ Mac10.7.3
Product Size	L269 x W114 x H166mm
Weight	1410g

9. Fast Forward

Film installed, the following for reference.

▶▶ **FastForward** , press **OK** to start FAST FORWARD, and then press **OK** to stop FASTFORWARD.

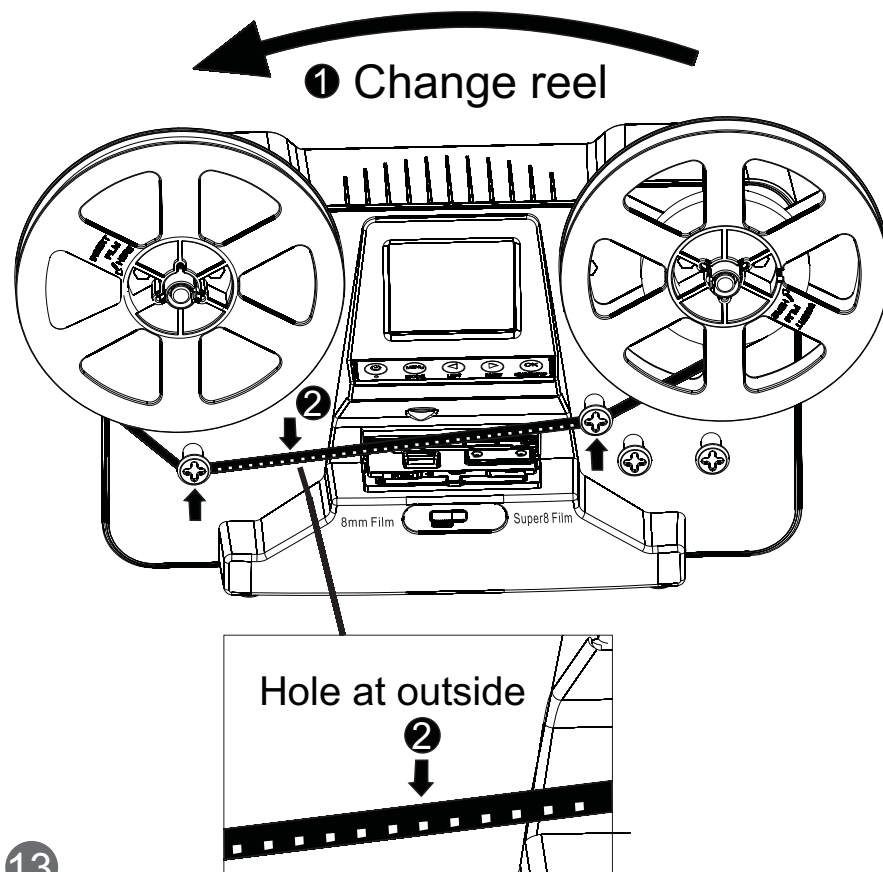

13

4.2 Reel hole diameter 13mm

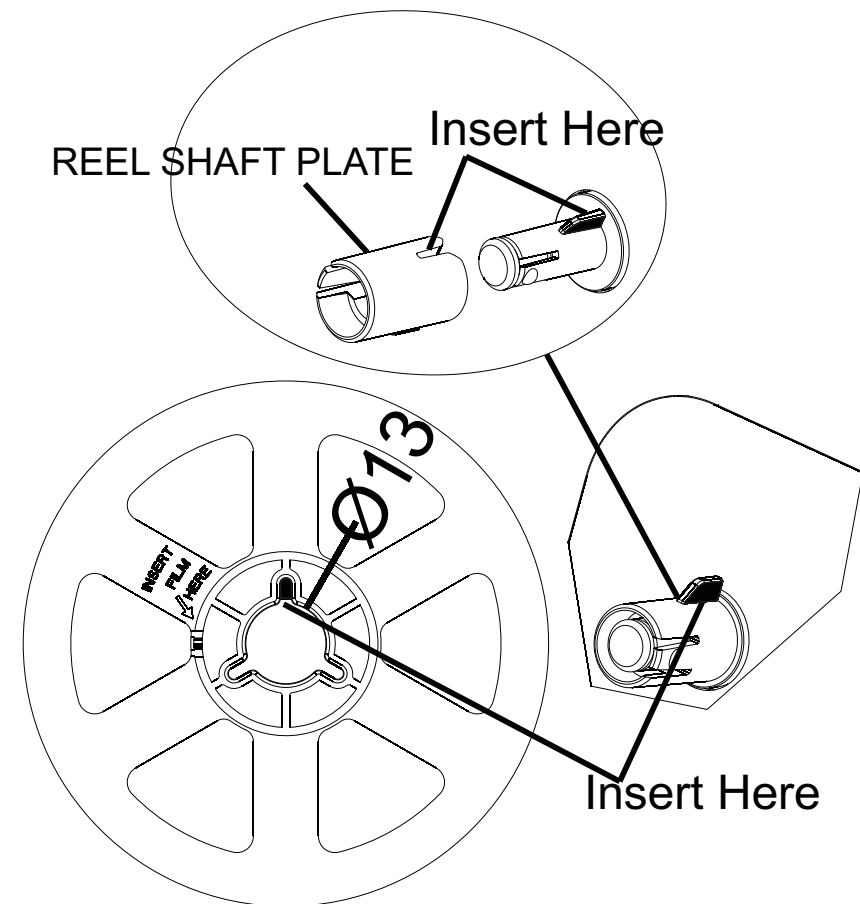

6

5. Film Install Methods

5.1 The structural representation

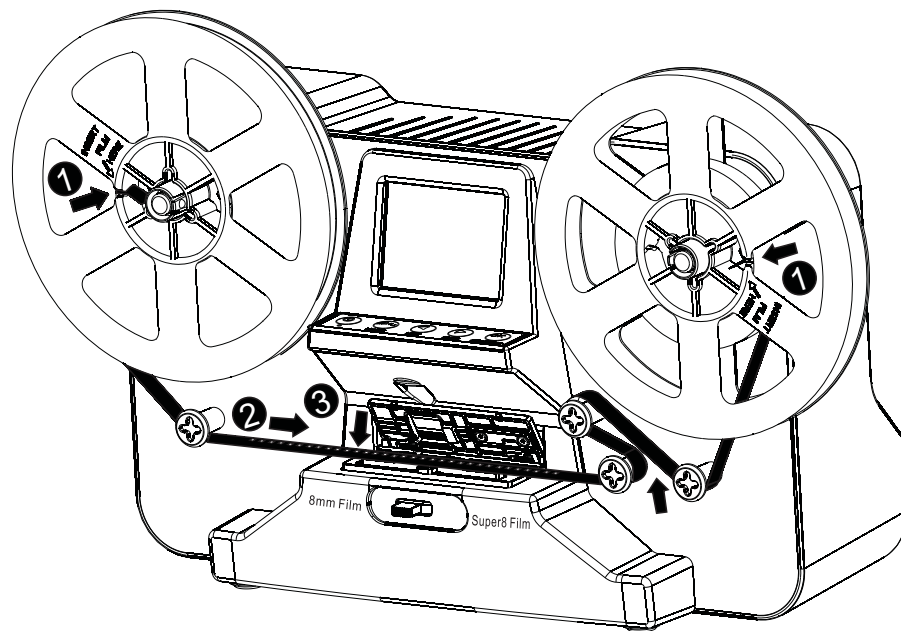

1	Menu	Option
2	Playback	Return/Delete/Protect
3	Fast Forward	Yes/No
4	Exposure Compensation	+2.0 ~ -2.0;
5	Language	English/French/ German/Italian/ Spanish/Japanese/ S Chinese/T Chinese
6		
	USB	USB UPLOAD/ INSERT USB CABLE
7	Format	Cancel/OK
8	Default Setting	Cancel/OK
9	Version	

Notice: The scanner will save the last setting you set when you shut it down.

8. Save the video to PC

Insert the USB cable, press **Menu** into MENU mode, select **USB**, press **OK** into upload mode. press **Menu** or unplug USB cable directly to stop upload mode and back to preview mode.

Uploading: into upload mode, Under the U-disk mode, you can copy or cut the files to the computer to play. You also can remove the SD card, use the card reader to read the data from the card.

7.Function Setting Menu

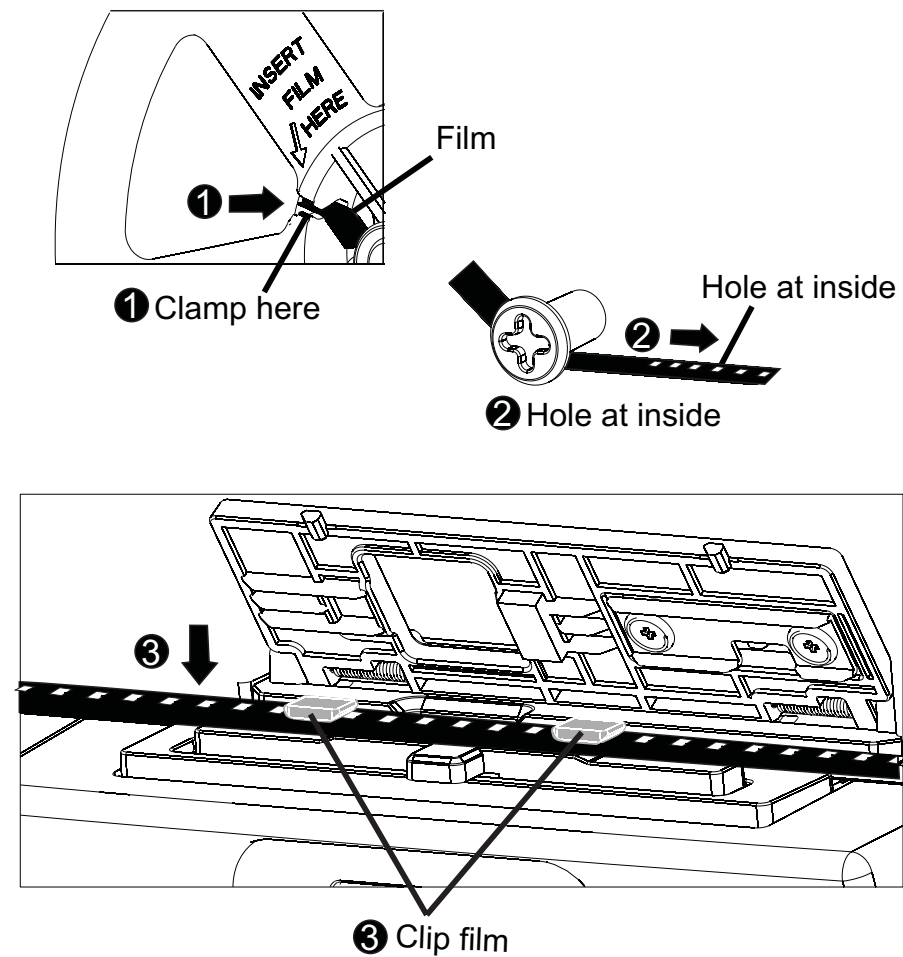
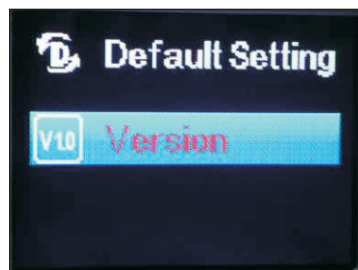

Press **Menu** into setting mode interface. And you can short press **◀/▶** to select the option. Press **OK** option is selected. After you selecting the option, press **Menu** again to exit.
Press **Menu** to enter the interface of system setting menu.



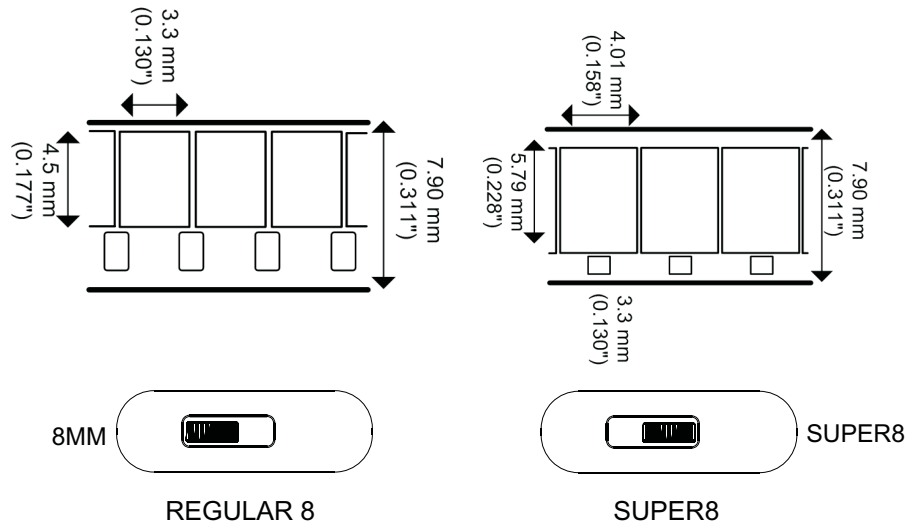

5.2 Please use available film







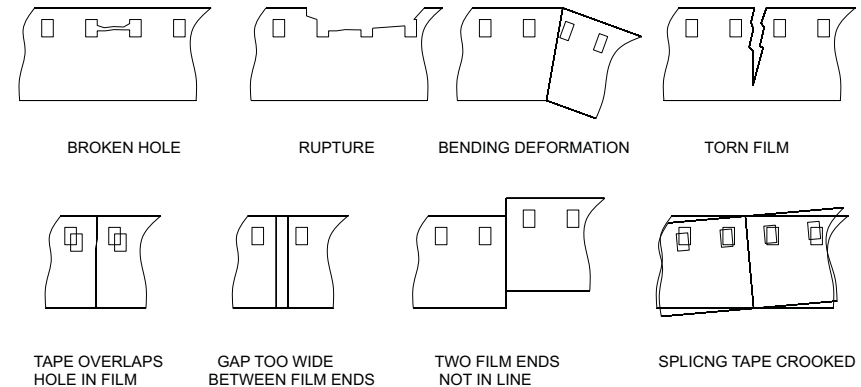

6. Power on/off

Power on : Insert the SD card (over class6),connect the power cable(DC12V), Press  into preview mode (the motor makes two round),status light turn on;
Power off : short presses  status light turn off.

Videorecording :press , into preview mode, press  to select the reel size after starting video, and then press  to stop the Video

- * the scanning speed is 2 fame/second. Please press "ok" to stop scanning 15seconds after it starts,if needed.
- * the red point light flash once per second on the screen and the display time will countdown when working
- * the item support auto stop after the film over.
- * please confirm your film is well preserved, the film as following is unavailable.

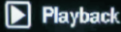

Playback: in preview mode,press  into menu option , press  or  select ,press  into Playback mode