

GS - SB 201L

BLUETOOTH SOUNDBAR



Contents

Controls And Functions	1
What's In The Box?	4
Support	5
User Manual	6
Using the AUX IN Cable	6
Using the ARC Input	7
Using the Optical Input	8
Using the MP3 Link Connection (Line In)	9
Connecting to the Mains Supply	10
Using the Bluetooth Operation	11
Using the USB Operation	12
Using the FM Mode	13
Troubleshooting	14
Specifications	15
Quick System Installation Guide	16
Safety Information	17



Controls And Functions

Side View/Control Buttons

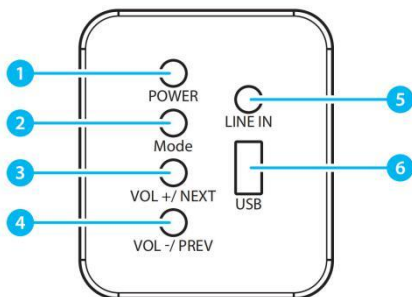

- | | |
|------------------|---------------------|
| 1. Power | 4. Volume-/Previous |
| 2. Mode | 5. Line In |
| 3. Volume +/Next | 6. USB Function |

Back View

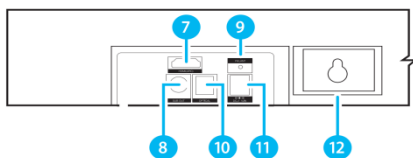

- | | |
|---------------------|--------------------|
| 7. HDMI ARC Input | 10. FM Antenna |
| 8. Subwoofer Output | 11. DC Power Input |
| 9. Optical Input | 12. Wall Bracket |

Remote Control

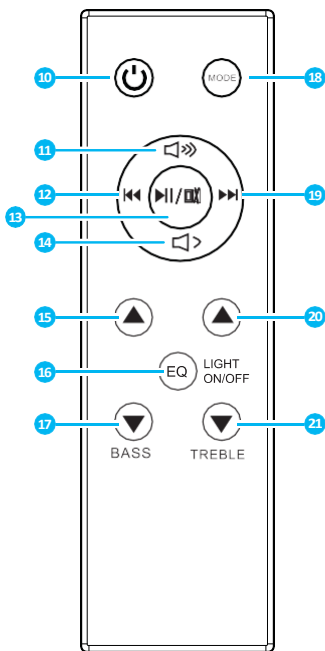

- 10. Power On/Off**
Switch the unit between on and Standby mode
- 11. Volume +**
Press to increase the volume
- 12. Back Step**
Use in AUX or Bluetooth mode to go back a track.
- 13. Play/Pause**
Press to play and pause
- 14. Volume -**
Press to decrease the volume
- 15. Bass Increase**
Press to increase the bass
- 16. EQ**
Press the button to adjust the equaliser. Press and **hold** the button to turn the soundbar LED light on and off.
- 17. Bass Decrease**
Press to decrease the bass
- 18. MODE**
Press button repeatedly to switch between soundbar modes
- 19. Forward Step**
Use in AUX or Bluetooth mode to go forward a track
- 20. Treble Increase**
Press to increase the treble
- 21. Treble Decrease**
Press to decrease the treble

Using the Remote Control

The remote control sensor at the front of the soundbar is sensitive to the remote control's commands up to a maximum of 8 metres away and within a maximum arc of 30 degrees.

Please note that the operating distance may vary depending on the brightness of the room.

Box Contents

1. GS-SB201L Soundbar
2. Remote Control
3. Power Adapter x 1
4. AUX IN Cable
5. Optical Cable
6. User Manual
7. 3.5mm to 3.5mm Line In Cable
8. 2 x Screws
9. 2 x Expanded Rubber Stopper



1. GS-SB201L Soundbar



2. Remote Control

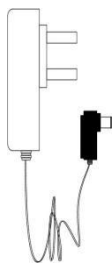

3. Power Adapter



4. AUX IN Cable



6. User Manual

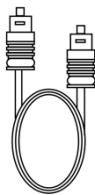

5. Optical Cable



7. 3.5mm to 3.5mm
Line In Cable

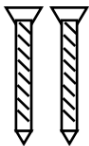

8. 2 x Screws



9. 2 x Expanded Rubber Stopper

Support

Thank you for your purchasing the GS-SB201L Soundbar.

Please follow the guidance of the user manual to set up your new purchase and begin enjoying its features.

Using the AUX IN Cable

Use the AUX Stereo Audio Cable (included) to connect the TV's stereo AUX (L/R) audio output socket.

Connect the audio output cable of the soundbar via the 'AUX' input sockets of the unit.

Then press **MODE** on the remote control (**Rem.18**) or press the Mode button on the unit to scroll to the AUX IN function.

Turn on your television

Troubleshooting: If you are not receiving a picture or encountering interference, please ensure that the AUX cable is being connected to 'output' AUX port on your TV set. This will ensure that the sound is being exported correctly.

If your TV does not have 'output' AUX port, please use an alternative connection method.

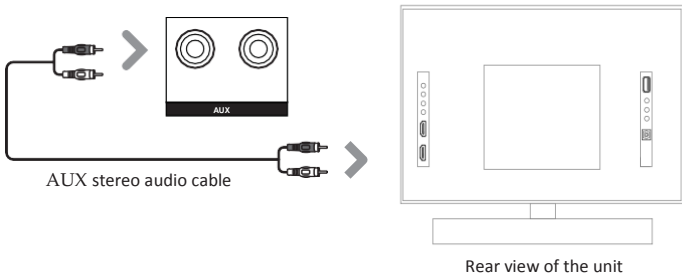

Using the ARC Input

You will need: An audio source with an ARC Audio Output and a ARC Audio cable (not included).

Connect the ARC Audio cable to the ARC output on the audio source and to the ARC Input on the soundbar.

Press the POWER button on the soundbar or POWER button directly on the remote control (**Rem.10**) to switch on the unit.

Press the MODE button on the remote control (**Rem.18**) to switch to ARC mode or select the Mode button on main unit repeatedly to select the ARC mode.

Using the native controls on your connected device, make sure the audio settings are set to ARC or HDMI Audio and are turned on. Audio from the connected audio source will now be played through the speakers.

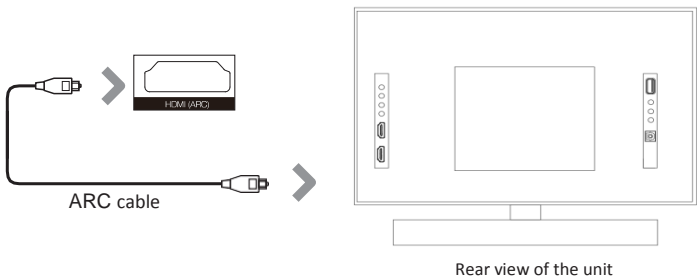

Using the Optical Input

You will need: An audio source with an Optical Audio Output and a Digital Optical Audio cable (included).

Connect the Digital Optical Audio cable to the optical output on the audio source and to the Optical Input on the soundbar.

Press the POWER button on the sound bar or POWER button directly on the remote control (**Ref.10**) to switch on the unit.

Press the MODE button on the remote control (**Rem.18**) to switch to Optical mode or select the Mode button on main unit repeatedly to select the Optical mode.

Using the native controls on your connected device, make sure the audio settings are set to PCM or Optical Audio and are turned On. Audio from the connected audio source will now be played through the speakers.

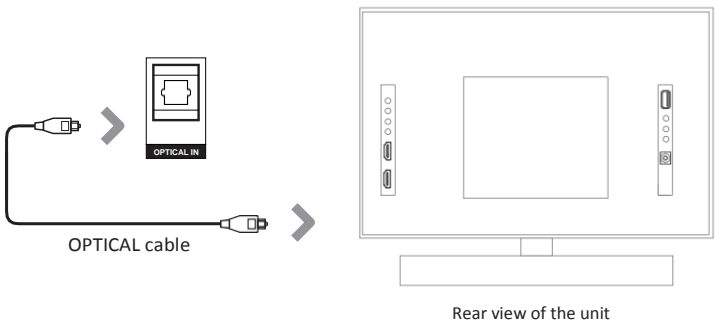

Using the MP3 Link Connection (Line In)

Plug one end of a 3.5mm to 3.5mm Line In cable (included) into the Line In port on the unit. Before use, disconnect any cables connected to the Stereo RCA Inputs.

Plug the other end of the cable into the audio output/headphone output on an MP3 player or other audio source.

Press the Power button on the soundbar or POWER button directly on the remote control (**Rem.10**) to switch on the unit.

Press the Mode button repeatedly on the soundbar or press the MODE button on remote control (**Rem.18**) repeatedly to enter LINE in mode.

Audio played through the connected device will now be heard through the speakers.

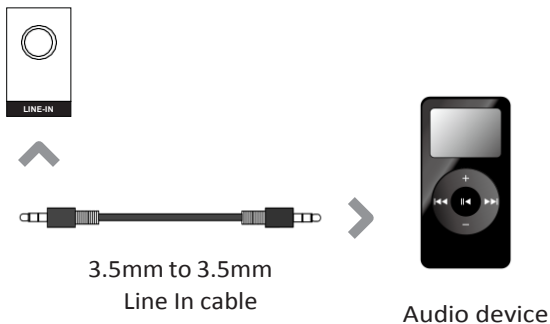

Connecting to the Mains Supply

Ensure that the power supply voltage is in the voltage of 100V~240V.

This unit is designed to use adapter.

Connecting the unit to any other power source may cause damage to the unit.

Unwind the mains cable to its full length.

Connect the mains plug to a mains socket.

Make sure the mains plug is fully inserted into the mains socket.

Connect the adapter to the unit via the DC input Socket.
(DC-18V-IN)

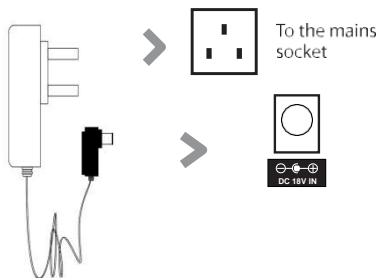

DC-in Power Cable



Ensure all audio connections of the unit are connected before connecting to the mains power socket.

Unplug the power cord from the outlet when the unit is use for an extended period of time.

Using the Bluetooth Operation

Pairing a Bluetooth Device for the First Time

Press the POWER button on the unit or the POWER button on the remote control (**Rem.10**) to switch on the unit.

Select and press the MODE button repeatedly on the remote control until in Bluetooth mode (**Rem.18**) or press the Mode button repeatedly on the sound bar to enter Bluetooth mode.

Using the native controls on your Bluetooth device, select the "GS-SB201L" in your Bluetooth settings to pair.

Refer to the user manual for your specific device for instructions on pairing and connecting Bluetooth devices.

When successfully paired and connected, a beep will issue from the unit. After initial pairing, the unit will stay paired unless unpaired manually by the user.

If your device should become unpaired or you find it is unable to connect, repeat the above steps.

Playing Audio Wirelessly

Follow the instructions for pairing a Bluetooth device.

Use the native controls on the connected Bluetooth Device to select a track.

To Play/Pause the track or Skip Forwards/Backwards to a selected track, use the remote control (**Rem.12,13,19**).

Audio played through the connected Bluetooth device will now be heard through the speakers.

Using the USB Operation

Insert USB to Play Music Automatically.

Select and press the MODE button repeatedly on the remote control until in USB mode (Rem.18) or press the Mode button repeatedly on the soundbar to enter USB mode.

To Play/Pause the track or Skip Forwards/Backwards to a selected track, use the remote control (**Rem.12,13,19**).

Audio played through the connected USB device will now be heard through the speakers.

Using the FM Mode

Select and press the MODE button repeatedly on the remote control (**Rem.18**) or press the Mode button on the soundbar repeatedly to enter FM (White) mode.

Ensure that the wire aerial on the back panel of the soundbar is extended.

When on FM mode, press and **hold** the 'Play/Pause' button on the remote (**Rem.13**) or on the soundbar to begin searching for available FM stations.

After the search is complete, the soundbar will save the stations with good signal. To scroll through these saved stations, press the 'Previous/Next' buttons on the remote control (**Rem.12/19**) .

Please note:

If you are having trouble with receiving stations, complete another auto-scan and adjust the aerial if needs be.

Troubleshooting

If the soundbar does not work properly as desired, please check the following.

Malfunction	Possible causes/measures
No power / function	Check whether the power is switched on or off at the wall. Check whether the power adaptor is properly connected to power outlet or not.
No sound	Check whether cables are properly installed. If they are, please try alternative cable to connect to your TV if possible. Check unit is out of standby and in mode.
No sound from bluetooth connection	Forget the soundbar from your device and reconnect.
Function disturbance	Switch off and unplug the unit. Leave it for 2 minutes and switch it on again. If a particular mode is causing problems, please try an alternative connection to your TV such as Optical or Bluetooth.
Remote control does not work [properly]	Check whether the battery run out or not. Replace with a new one if necessary. Check whether there is obstacle on the front of remote sensor.

Specifications

Power Supply	DC 18V / 1.3A
Power Consumption	40W
Power Output (RMS)	20W
Speaker Size	2 inch
Number of Speakers	4
Working environment (Temperature)	-10~ + 55C
Relative Humidity	5% ~ 90%
Frequency Response	+/- 3dB
Bluetooth	V5.0
Dimension (LxWxH)	80 x 6.1 x 6.0 cm (Soundbar)

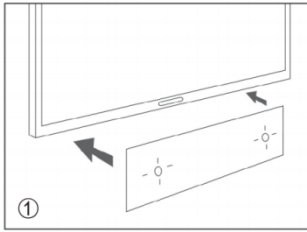

Place the paper guide on the wall where you want to hang the soundbar.

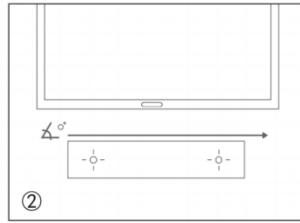

Verify with a level gauge that the inclination angle of the soundbar is zero degrees.

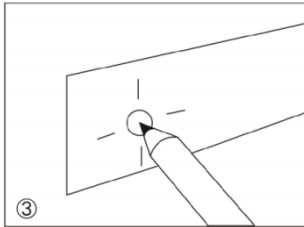

Locate the screw holes on the paper guide and mark a point with a pencil.

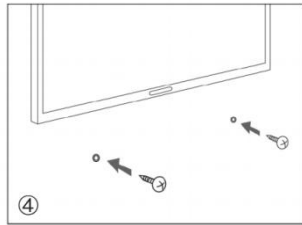

Make the holes with the corresponding drill bit according to the type of wall.

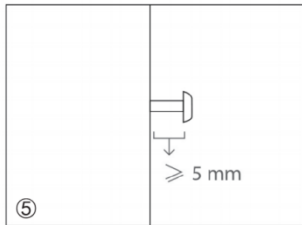

It is advisable to leave no more than 5mm between the head of the screw and the wall to minimize the inclination angle of the soundbar.

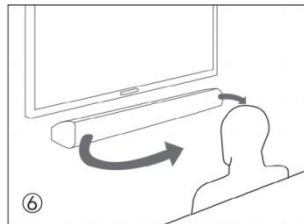

For a better sound experience, it is advisable to place the soundbar at the same height of the ear.

1. Read these **user manual**.
2. Keep these **user manual**.
3. Heed all Warnings
4. Follow all instructions
5. Do not clean the apparatus near or with water
6. Do not block any ventilation openings. Install in accordance with the manufacturer's instructions
7. Do not install near any heat sources such as radiators, heat registers, stoves, or other apparatus (including amplifiers) that produce heat.
8. Protect the power from being walked on or pinched particularly at plugs, convenience receptacles, and the point where they exit from the apparatus.
9. Only use attachments/accessories specified by the manufacturer.
10. Unplug this apparatus during light storms or when unused for long periods of time.
11. Refer all servicing to qualified service personnel. Servicing is required when the apparatus has been damaged in a way, such as power-supply cord or plug is damaged, liquid has been spilled or objects have fallen into the apparatus, the apparatus has been exposed to the rain or moisture, does not operate normally or has been dropped.
12. No naked flame sources, such as lit candles, should be placed on the apparatus.
13. Dispose of used electrical products and batteries safely according to your local authority and regulations.

ADDITIONAL WARNINGS

The apparatus shall not be exposed to dripping or splashing and no objects filled with liquid, such as vases, shall be placed on the apparatus.

Main plug is used to disconnect device and it should remain readily operable during intended use. In order to disconnect the apparatus from the main mains completely, the mains plug should be disconnected from the main socket outlet completely.

Battery shall not be exposed to excessive heat such as sunshine, fire or the like.

RECYCLING ELECTRICAL PRODUCTS

You should now recycle your waste electrical goods and in doing so help the environment.



This symbol means an electrical product should not be disposed of with normal household waste. Please ensure it is taken to a suitable facility for disposal when finished with.

IMPORTANT: Please read all instructions carefully before use and keep for future reference.



Risk of electric shock.
Do not open



Read all instructions carefully before use and keep for future reference



When servicing, use only identical replacement parts



CAUTION

RISK OF ELECTRIC SHOCK DO NOT OPEN



IMPORTANT: Please read all instructions carefully before use and keep for future reference.

